

# Shinhoo



## BASIC SERIES CIRCULATION PUMPS

Anhui Shinhoo Canned Motor Pump Co., Ltd.

Address: No.780, Ming Chuan Road, High-Tech Zone,  
Hefei, Anhui, P.R. China  
Tel.: +86-551-62379807  
E-mail: info@shinhoodump.com

For information only. Technical modifications are possible.  
All rights reserved.

MADE TO LAST FOR YEARS

MADE TO LAST FOR YEARS

# Contents

Company Profile

Structural Diagram

Structure

Bill of Material

Type Key

Application

Product Selection

Installation

Working Conditions

Parameter Table for 270W Pumps and Below

Parameter Table for 300W Pumps and Above

Basic Series Circulation Pumps



## Company Profile

(Shinhoo) As a wholly-owned subsidiary of Zhejiang Dayuan Pumps Industrial Co., Ltd. (Shanghai Stock Exchange-stock code: 603757) , Shinhoo is specialized in canned motor pump manufacturing. In order to satisfy the rising market demands, in 2007 our large production base was constructed with the total investment of 300 million Chinese Yuan in National Hi-tech Development Zone in Hefei, Anhui Province, P.R. China. At the end of 2009, our new plant with the floor area of 100,000 square meters started running. Based on the standard of ISO 9001:2015 Quality Management System, ISO14001:2015 Environment Management System and OHSAS18001:2007 Occupation Health and Safety Management System, Shinhoo established a complete set of design, producing, marketing and service system. As required by different countries and areas, our related products successfully obtained certifications such as CCC, GS, UL and CE as well as passed required tests such as RoHS, REACH and EEL. All of these ensured the safety, stability, reliability, durability and legality of our products in the market. We have formed our own core competitiveness as well as the space for sustainable development with sufficient material resources, reinforced regulation system and hightech talents we gathered.

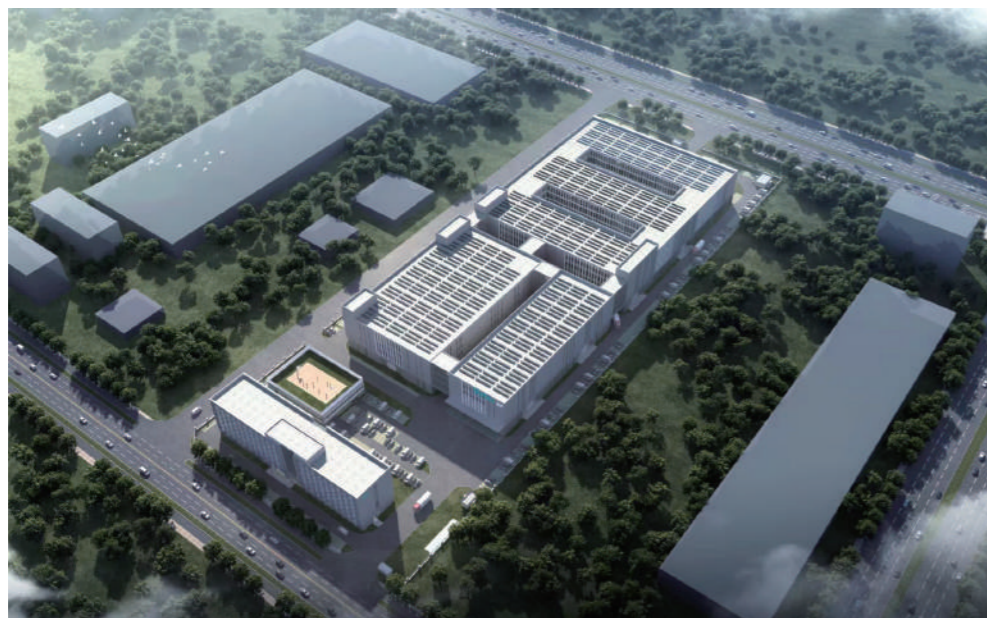

## Structure

1. Pump contains two parts: hydraulic section and motor(with wet rotor). Hydraulic section contains pump housing , impeller while motor includes stator, rotor, cartridge and air-venting nut.
2. Sealing: the pump does not use mechanical seal. Stator and rotor are sealed with cartridge made of stainless steel and two heat-resistant rubber rings, which ensure no leakage.
3. Lubrication of bearings and cooling of motor by inner circulation of pumped liquid.
4. Insulation class H, one speed or three speeds.

## Material table

No.	Name	Material
1	Pump housing	Cast iron/Stainless steel/Plastic/Brass/Bronze
2	Impeller	Engineering plastic/Stainless steel
3	Shaft	Ceramic/ Stainless steel
4	Bearing base	Stainless steel
5	Thrust bearing	Impregnated Carbon/ Silicon Carbide
6	Bearing	Ceramic/ Silicon carbide
7	Base of thrust bearing	Stainless steel/ Rubber
8	Shield cover	Stainless steel
9	Connection	Cast iron/Stainless steel/Brass



Stainless Steel



Cast Iron



Brass



Plastic

# Structural Diagram

BASIC SERIES

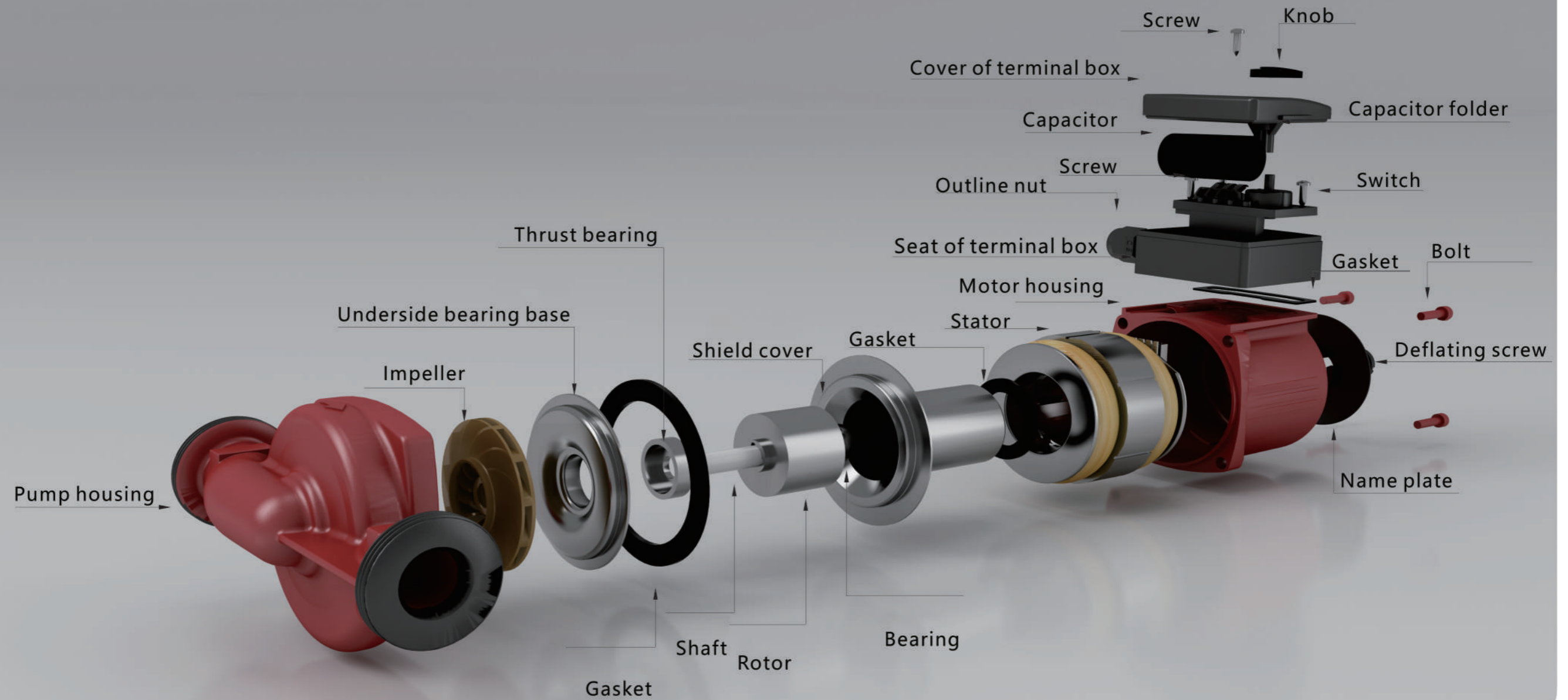

## Type key

Name of model is formed of uppercase latin letters and arabic numbers. Its meaning is as following:

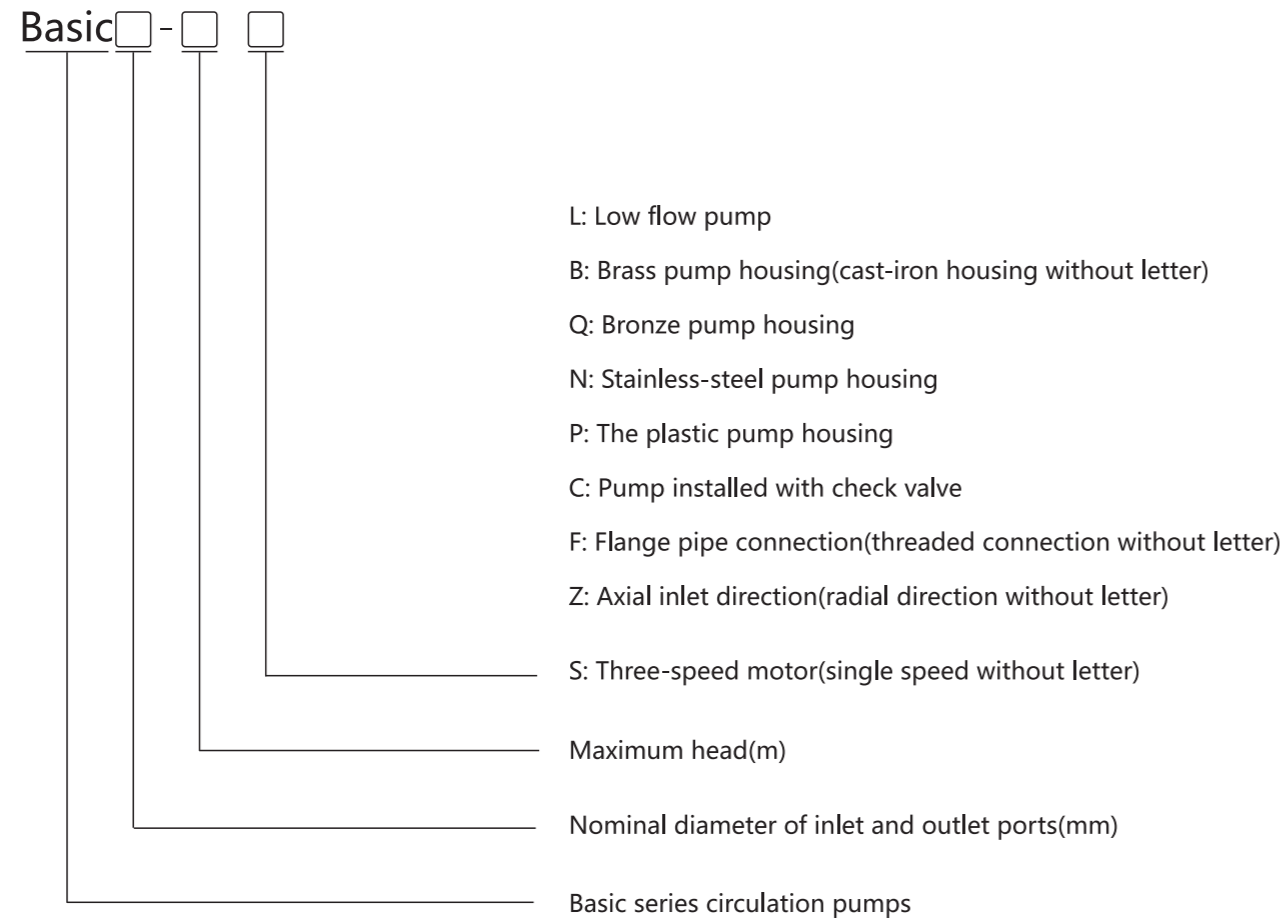

Example: Basic25-12SB is three-speed pump with brass pump housing . The inlet and outlet is DN25, max. head is 12 m.

## Application

Basic canned motor circulation pumps designed and produced by our specialists have these features: low noise, no leakage, ecological safety in operation, artistic appearance, easy installation and reliable operation. Pumps can be used in single pipe or double pipe heating system, also can be applied to city apartments, suburb villa, cooling, air-conditioning, boilers and solar systems etc.

## Product selection

Users can select a model from the type spectra according to the requirement of head and flow.

Basic series have two kinds of pipe connections: threaded and flange. Models with power above 300W mainly have flange connection. We can make customized design according to your needs.

Pump housing is generally made of cast iron. Bronze and stainless steel pump housing is also available.

Pump with cast iron housing is widely used for delivering water for room heating. Pump with bronze housing is largely used in the floor heating system. For delivering domestic hot water we recommend using pump with stainless steel housing(Basic-N) or bronze housing(Basic-B).

## Installation

During installation, the shaft of pump should be parallel to ground. Before start-up, open the venting screw on the top of the motor so that air in the pump can be released well, and then re-fasten the venting screw. This will help preventing pump from dry running.

## Working Conditions

1. Power supply: voltage 230V, frequency 50Hz, single-phase AC power and three-phase AC power with voltage of 380V and frequency of 50Hz. The models listed in the table can also be manufactured according to user's requirement as 230V/60Hz or 115V/60Hz. Curve and performance parameters in this table represent only products with power supply of 230V/50Hz.
2. Maximum system pressure: 1.0MPa.
3. Ambient temperature: 0°C ~ 40°C, temperature of medium: 2 °C ~ 110 °C. In order to avoid condensed water in stator, make sure the ambient temperature is lower than liquid temperature.
4. Medium: thin, clean, non-corrosive and non-explosive liquid, does not contain any solid particles, fibers or mineral oil. Pump must not be used for delivering flammable liquids, such as diesel and gasoline. Delivering liquid of high viscosity will reduce performance of the pump, so while choosing a pump, the viscosity of the medium must be taken into consideration.
5. Maintain minimum pressure at the pump inlet to avoid cavitation noise and damage to pump bearings.

# Working Conditions

For pumps with power below 270W, the inlet minimum water pressure should be maintained as following:

Liquid Temperature	85°C	90°C	110°C
Inlet Pressure	6 Head(m) 0.6 bar	7.5 Head(m) 0.75 bar	15 Head(m) 1.5 bar

For pumps with power above 300W, the inlet minimum water pressure is different for each model, see following details:

Model	Liquid Temperature			(W)
	70°C(bar)	90°C(bar)	110°C(bar)	
Basic 20-12Z	0.45	0.75	1.60	300
Basic 20-12SZXL	0.45	0.75	1.60	300
Basic 20-16Z	0.65	1.05	1.85	500
Basic 20-16SZXL	0.65	1.05	1.85	500
Basic 20-20SZ	0.80	1.10	1.70	700
Basic 20-26SZ	0.80	1.10	1.70	1000
Basic 20-35SZ	0.50	1.05	1.70	1300
Basic 25-9	0.35	0.75	1.20	300
Basic 25-9SXL	0.35	0.75	1.20	300
Basic 25-9Z	0.35	0.75	1.20	300
Basic 25-9SZXL	0.35	0.75	1.20	300
Basic 25-12L	0.35	0.75	1.20	300
Basic 25-12SL	0.35	0.75	1.20	300
Basic 25-12	0.40	0.75	1.40	500
Basic 25-12SXL	0.40	0.75	1.40	500
Basic 25-12Z	0.45	0.75	1.60	500
Basic 25-12SZXL	0.45	0.75	1.60	500
Basic 25-16S	0.80	1.10	1.70	700
Basic 25-16SZ	0.80	1.10	1.70	700
Basic 25-20S	0.70	0.95	1.60	1000
Basic 25-20SZ	0.70	0.95	1.60	1000
Basic 32-9	0.35	0.75	1.20	300
Basic 32-9SXL	0.35	0.75	1.20	300
Basic 32-9F	0.35	0.75	1.20	300
Basic 32-9SFXL	0.35	0.75	1.20	300
Basic 32-12	0.40	0.75	1.40	500
Basic 32-12SXL	0.40	0.75	1.40	500
Basic 32-12F	0.40	0.75	1.40	500
Basic 32-12SFXL	0.40	0.75	1.40	500
Basic 32-16S	0.80	1.10	1.70	700
Basic 32-20S	0.70	0.95	1.60	1000

For pumps with power above 300W, the inlet minimum water pressure is different for each model, see following details:

Model	Liquid Temperature			(W)
	70°C(bar)	90°C(bar)	110°C(bar)	
Basic 40-4.5F	0.35	0.75	1.45	300
Basic 40-4.5SFXL	0.35	0.75	1.45	300
Basic 40-6F	0.15	0.75	1.20	500
Basic 40-6SFXL	0.15	0.75	1.20	500
Basic 40-12SF Pro	0.40	0.80	1.55	700
Basic 40-16SF Pro	0.40	0.75	1.40	1000
Basic 50-12SF Pro	0.40	0.75	1.40	1000
Basic 50-16SF Pro	0.65	1.10	1.70	1300
Basic 50-20SF Pro	0.65	1.10	1.70	1500
Basic 65-8SF Pro	0.40	0.75	1.40	700
Basic 65-12SF Pro	0.40	0.75	1.40	1300
Basic 65-15SF Pro	0.40	0.75	1.40	1500
Basic 65-18SF	0.40	0.75	1.40	1800
Basic 80-8SF Pro	0.65	1.10	1.70	1000
Basic 80-10SF Pro	0.65	1.10	1.70	1300
Basic 80-12SF Pro	0.65	1.10	1.70	1500

# Product List

Model	Max. Flow (m <sup>3</sup> /h)	Max head (m)	Power (w)	Rated Flow (m <sup>3</sup> /h)	Rated Head (m)	Rated Current(A)		Voltage (V)		Housing material					
						115V	230V	115	230	Cast Iron	Plastic	Brass	Stainless steel	Bronze	
Instant E	0.6	1.4	28W	0.3	1.1		0.28			●				●	
Basic 20-4S	2.5	4.0	65/50/32	1.6	2.6	0.56/0.44/0.30	0.28/0.22/0.15	●	●	●	●	●			●
Basic 25-4S	2.8	4.0	65/50/32	1.6	2.6	0.56/0.44/0.30	0.28/0.22/0.15	●	●	●			●		●
Basic 32-4S	3.5	4.0	65/50/32	1.8	2.6	0.56/0.44/0.30	0.28/0.22/0.15	●	●	●					
Basic 20-5S	2.8	5.0	85/60/40	1.8	3.2	0.80/0.60/0.44	0.40/0.30/0.22	●	●	●	●	●			●
Basic 25-5S	3.0	5.0	85/60/40	1.8	3.2	0.80/0.60/0.44	0.40/0.30/0.22	●	●	●			●		●
Basic 32-5S	4.0	5.0	85/60/40	2.5	2.8	0.80/0.60/0.44	0.40/0.30/0.22	●	●	●					
Basic 20-6S	2.8	6.0	100/70/55	1.8	3.6	0.90/0.70/0.50	0.45/0.35/0.25	●	●	●	●	●			●
Basic 25-6S	3.0	6.0	100/70/55	2.0	3.5	0.90/0.70/0.50	0.45/0.35/0.25	●	●	●			●		●
Basic 32-6S	4.0	6.0	100/70/55	2.0	3.5	0.90/0.70/0.50	0.45/0.35/0.25	●	●	●					
Basic 20-7S Pro	3.5	7.0	160/115/70	2.0	4.3		0.73/0.52/0.33		●	●	●	●			●
Basic 25-7S Pro	3.5	7.0	160/115/70	2.5	4.0		0.73/0.52/0.33		●	●		●			●
Basic 32-7S Pro	5.3	7.0	160/115/70	2.5	4.9		0.73/0.52/0.33		●	●					
Basic 20-8SL	4.0	7.6	180/150/90	2.0	6.0		0.85/0.70/0.45		●	●					
Basic 25-8SL	4.5	7.6	180/150/90	2.0	6.0		0.85/0.70/0.45		●	●					
Basic 32-8SL	6.0	7.6	180/150/90	2.0	6.0		0.85/0.70/0.45		●	●					
Basic 25-8S	5.2	8.0	245/190/135	3.2	6.0	2.20/1.70/1.20	1.1/0.85/0.60	●	●	●	●	●			●
Basic 32-8S	8.0	8.0	245/190/135	4.0	5.5	2.20/1.70/1.20	1.1/0.85/0.60	●	●	●					
Basic 32-8SF	8.0	8.0	245/190/135	4.0	5.5	2.20/1.70/1.20	1.1/0.85/0.60	●	●	●					
Basic 40-8SF	8.0	8.0	245/190/135	4.0	5.5	2.20/1.70/1.20	1.1/0.85/0.60	●	●	●					
Basic 15-9S	1.8	9.0	120/80/65	1.0	5.5	1.00/0.80/0.60	0.50/0.40/0.30	●	●	●					
Basic 15-12S	3.5	12.0	270/240/160	2.0	9.5	2.40/2.20/1.50	1.20/1.10/0.75	●	●	●					
Basic 20-12S	4.0	12.0	270/240/160	2.0	9.5	2.40/2.20/1.50	1.20/1.10/0.75	●	●	●			●		
Basic 25-12S	4.0	12.0	270/240/160	2.0	9.5	2.40/2.20/1.50	1.20/1.10/0.75	●	●	●			●		
Promo 15-9A	1.5	9.0	120	0.5	7.5	1.0	0.5	●	●	●			●		
Promo 15-12A	2.8	12.0	270	1.2	10.0	2.4	1.2	●	●	●					

● represents optional product specification.

Model	Max. Flow (m <sup>3</sup> /h)	Max head (m)	Power(W) 230V	Power(W) 380V	Rated Flow (m <sup>3</sup> /h)	Rated Head (m)	Rated Current(A)			Voltage (V)			Housing material				
							115V	230V	380V	115	230	380	Cast Iron	Plastic	Brass	Stainless steel	Bronze
Basic 40-4SF	10	4.5	300		8	3.2	3	1.5		●	●		●				
Basic 40-4SFXL	10	4.5	300/280/260		8	3.2		1.5/1.4/1.3		●	●		●				
Basic 40-6F	13	7	500		12	4.5	5	2.5		●	●		●				
Basic 40-6SFXL	13	7	500/460/440		12	4.5		2.5/2.3/2.0		●	●		●				
Basic 65-8SF Pro	25	8	700/550/410	700/580/500	20	3		3.4/2.4/1.8	2.05/1.03/0.87		●	●	●				
Basic 80-8SF Pro	32	8	1000/860/580	1000/770/670	25	5		4.9/3.8/2.6	2.30/1.30/1.20		●	●	●				
Basic 25-9	6	9	300		5	5	3	1.5		●	●		●			●	
Basic 32-9	8	9	300		5	6.5	3	1.5		●	●		●				
Basic 32-9F	8	9	300		5	6.5	3	1.5		●	●		●				
Basic 25-9SXL	6	9	300/280/260		5	5		1.5/1.4/1.3		●	●		●			●	
Basic 32-9SXL	8	9	300/280/260		5	6.5		1.5/1.4/1.3		●	●		●				
Basic 32-9SFXL	8	9	300/280/260		5	6.5		1.5/1.4/1.3		●	●		●				
Basic 80-10SF Pro	35	10	1300/1100/800	1300/1000/930	25	8		5.8/4.9/3.5	3.05/1.75/1.60		●		●				
Basic 25-12L	6	12	300		3.5	9	3	1.5		●	●	●	●				
Basic 25-12	6.5	12	500		5	8.5	5	2.5		●	●		●			●	
Basic 32-12	9	12	500		6	8	5	2.5		●	●		●				
Basic 32-12F	9	12	500		6	8	5	2.5		●	●		●				
Basic 25-12SL	6	12	300/280/260		3.5	9		1.5/1.4/1.3		●	●		●				
Basic 25-12SXL	6.5	12	500/460/440		5	8.5		2.5/2.3/2.0		●	●		●			●	
Basic 32-12SXL	9	12	500/460/440		6	8		2.5/2.3/2.0		●	●		●				
Basic 32-12SFXL	9	12	500/460/440		6	8		2.5/2.3/2.0		●	●		●				
Basic 40-12SF Pro	11	14	700/550/410	700/580/500	8	10		3.4/2.4/1.8	2.05/1.03/0.87		●	●	●				
Basic 50-12SF Pro	28	12	1000/860/580	1000/770/670	16	8		4.9/3.8/2.6	2.30/1.30/1.20		●	●	●				
Basic 65-12SF Pro	36	12	1300/1100/800	1300/1000/930	20	10		5.8/4.9/3.5	3.05/1.75/1.60		●	●	●				
Basic 80-12SF Pro	40	12		1500/1250/1100	25	10		3.50/2.05/1.85			●	●					
Basic 65-15SF Pro	38	14		1500/1250/1100	20	11		3.50/2.05/1.85			●	●					
Basic 25-16S	9	16	700/550/410	700/580/500	7	12.5		3.4/2.4/1.8	2.05/1.03/0.87		●	●	●				

● represents optional product specification.

# Product List

Model	Max. Flow (m³/h)	Max head (m)	Power(W) 230V	Power(W) 380V	Rated Flow (m³/h)	Rated Head (m)	Rated Current(A)			Voltage (V)			Housing material						
							115V	230V	380V	115	230	380	Cast Iron	Plastic	Brass	Stainless steel	Bronze		
Basic 40-16SF Pro	13	18	1000/860/580	1000/770/670	8	13.5		4.9/3.8/2.6	2.30/1.30/1.20		•	•	•						
Basic 50-16SF Pro	30	15.5	1300/1100/800	1300/1000/930	16	12		5.8/4.9/3.5	3.05/1.75/1.60		•	•	•						
Basic 32-16S	12	16	700/550/410	700/580/500	7	12.5		3.4/2.4/1.8	2.05/1.03/0.87		•	•	•						
Basic 65-18SF	35	17		1800/1450/1350	20	12			3.60/2.37/2.27			•	•						
Basic 25-20S	10	20	1000/860/580	1000/770/670	9	14		4.9/3.8/2.6	2.30/1.30/1.20		•	•	•						
Basic 50-20SF Pro	35	17		1500/1250/1100	16	13.5			3.50/2.05/1.85			•	•						
Basic 25-9Z	6	9	300		5	5	3	1.5			•	•	•						
Basic 20-12Z	4.5	13	300		2	10	3	1.5			•	•	•		•			•	
Basic 25-12Z	6.5	12	500		5	8.5	5	2.5			•	•	•						
Basic 20-16Z	5	16	500		3	11.5	5	2.5			•	•	•		•			•	
Basic 25-9SZXL	6	9	300/280/260		5	5		1.5/1.4/1.3			•	•	•						
Basic 20-12SZXL	4.5	13	300/280/260		2	10		1.5/1.4/1.3			•	•	•						
Basic 25-12SZXL	6.5	12	500/460/440		5	8.5		2.5/2.3/2.0			•	•	•						
Basic 20-16SZXL	5	16	500/460/440		3	11.5		2.5/2.3/2.0			•	•	•		•			•	
Basic 25-16SZ	9	16	700/550/410	700/580/500	7	12.5		3.4/2.4/1.8	2.05/1.03/0.87		•	•	•						
Basic 20-20SZ	8	20	700/550/410	700/580/500	5	16		3.4/2.4/1.8	2.05/1.03/0.87		•	•	•						
Basic 25-20SZ	10	20	1000/860/580	1000/770/670	9	14		4.9/3.8/2.6	2.30/1.30/1.20		•	•	•						
Basic 20-26SZ	9	26	1000/860/580	1000/770/670	7	18		4.9/3.8/2.6	2.30/1.30/1.20		•	•	•						
Basic 20-35SZ	10	30	1300/1100/800	1300/1000/930	5	25		5.8/4.9/3.5	3.05/1.75/1.60		•	•	•						
Basic 32-20S	13	20	1000/860/580	1000/770/670	9	14		4.9/3.8/2.6	2.30/1.30/1.20		•	•	•						

• represents optional product specification.



## Promo 15-9A

Promo compact pressure booster pumps



## Instant E

Instant circulator pump



# Performance Curve

Instant E

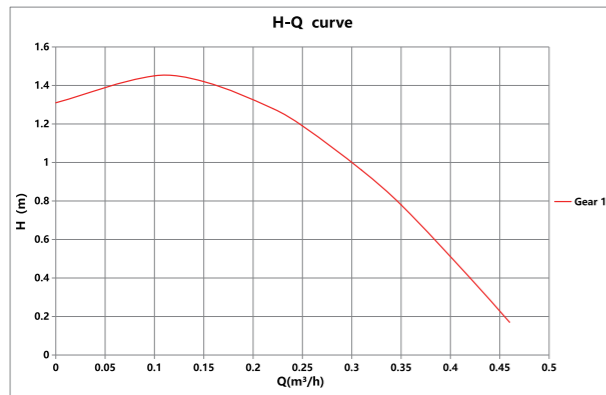

Promo 15-9A

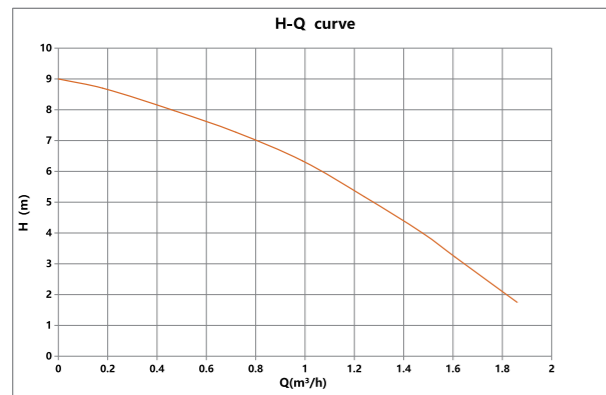

Promo 15-12A

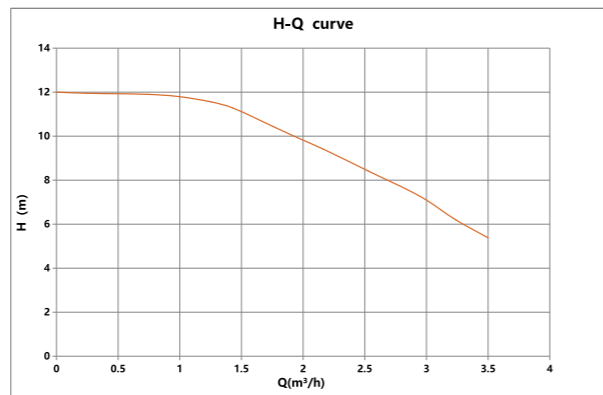

## Installation Drawing

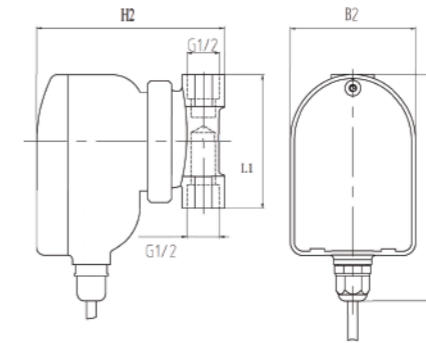

Pump model	Dimension						weight(kg)		Connection/Flange	Package size (mm×mm×mm)	Package type	Sets/ box
	L1	H1	H2	B1	B2	G	N.W	G.W				
Instant E	85	/	120	40	80	½"	1.5	1.6	/	360×300×310	Carton	8

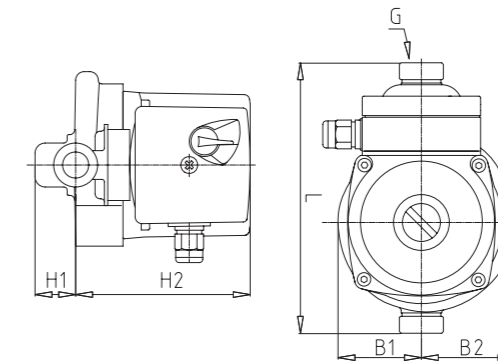

Pump model	Dimension						Weight(kg)		Connection/Flange	Package size (mm×mm×mm)	Package type	Sets/ box
	L1	H1	H2	B1	B2	G	N.W	G.W				
Promo 15-9A	160	23	103	50	54	¾"	2.5	2.7	¾"-½"	360×300×310	Carton	8
Promo 15-12A	200	18	132	63	69	¾"	2.5	2.7	¾"-½"	420×350×205	Carton	4

## Product Parameters

Pump model	Max flow (m³/h)	Max head (m)	Power (W)	Rated flow (m³/h)	Rated head (m)	Rated current (A)		Voltage		Housing material							
						115V	230V	115V	230V	Cast Iron	Plastic	Brass	Stainless steel	Bronze			
Instant E	0.55	1.4	28W	0.25	1.1		0.28										
Promo 15-9A	2	9	120	1	8	1.0	0.5	●	●	●	●	●	●	●			
Promo 15-12A	3	12	270	1	10	2.4	1.2	●	●	●							

● Indicates Optional Product Specifications



# Performance Curve



## Basic series circulation pumps

Basic 20-4S

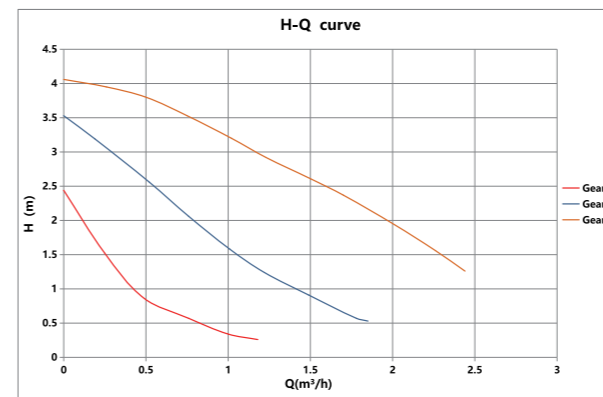

Basic 25-4S

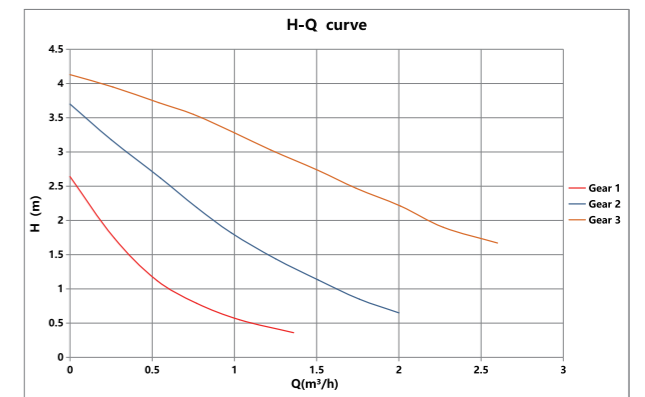

Basic 32-4S

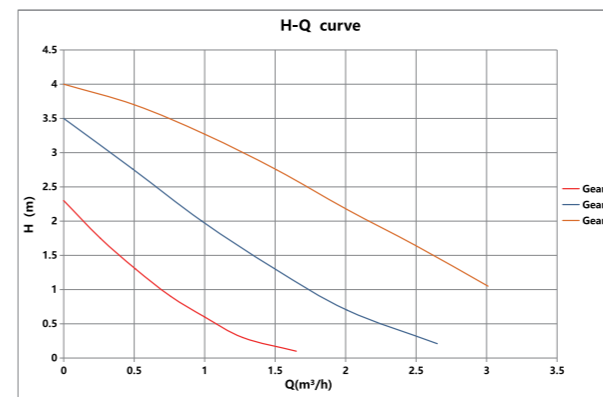

Basic 20-5S

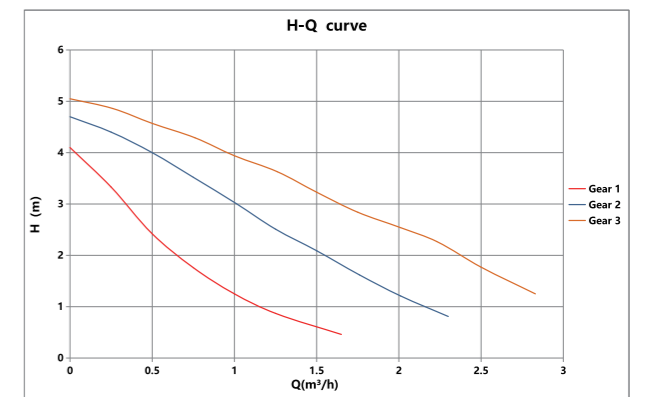

# Performance Curve

### Basic 25-5S

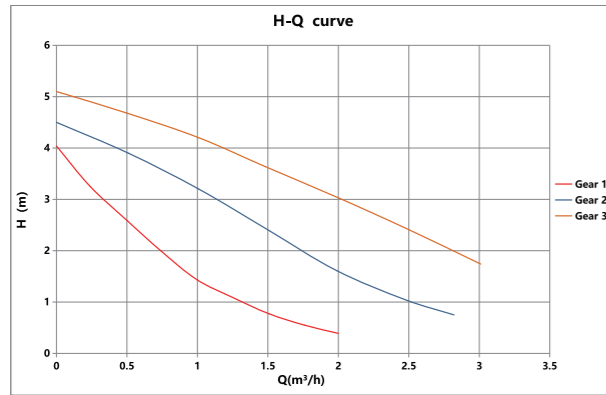

### Basic 32-5S

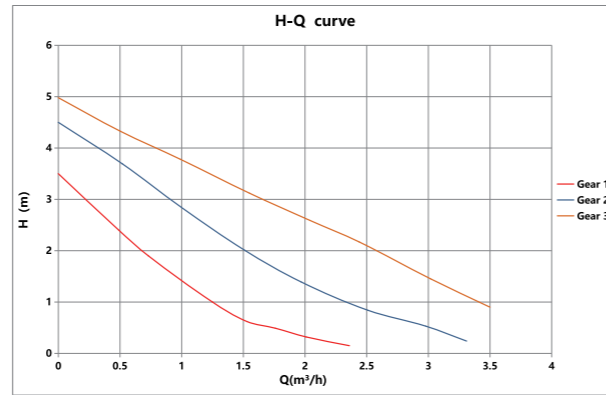

### Basic 25-7S Pro

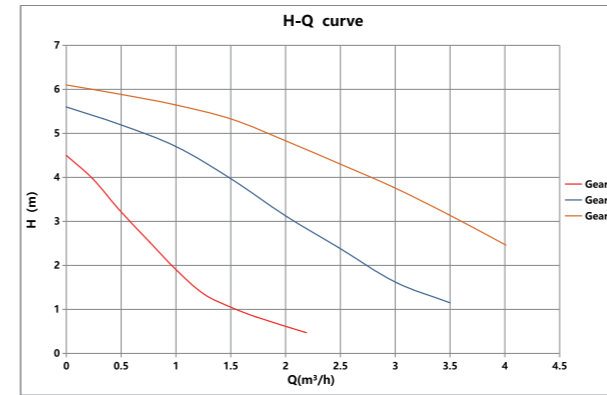

### Basic 32-7S Pro

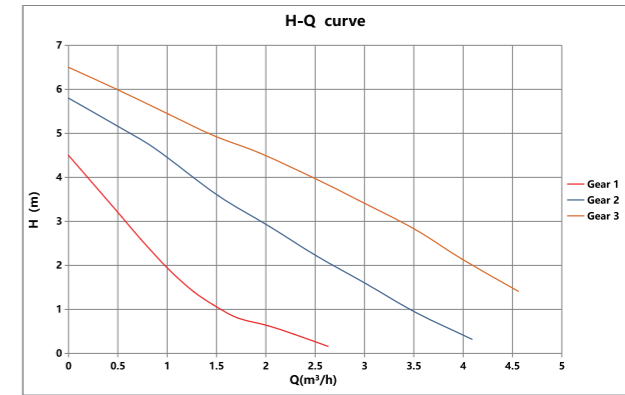

### Basic 20-6S

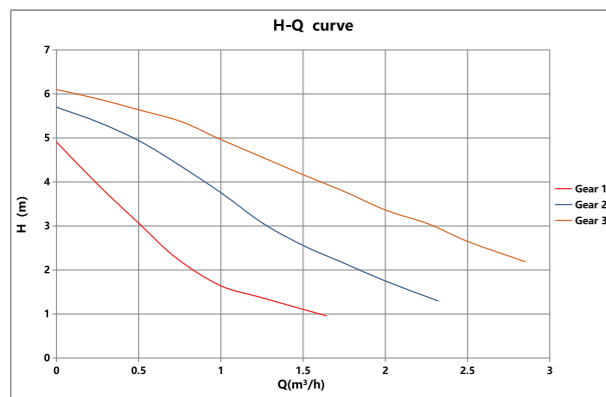

### Basic 25-6S

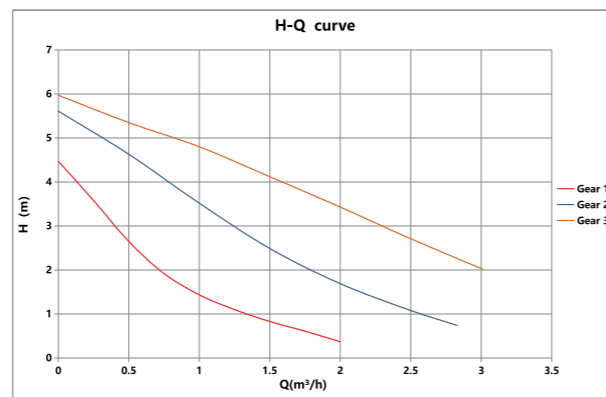

### Basic 25-8S

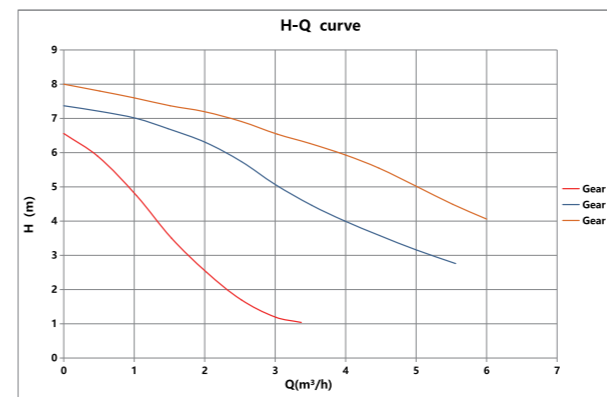

### Basic 32-8S

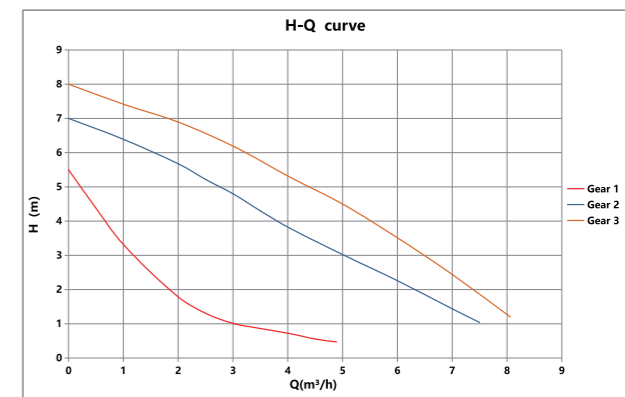

### Basic 32-6S

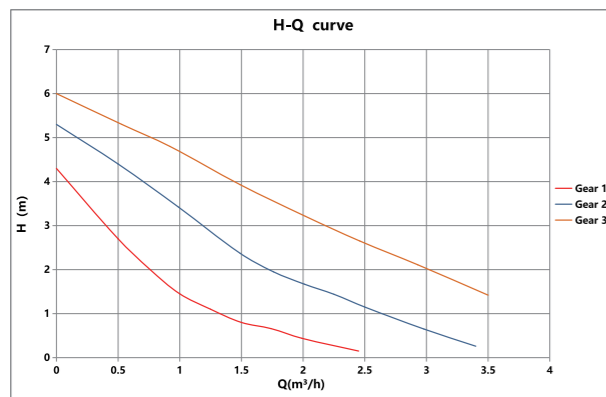

### Basic 20-7S Pro

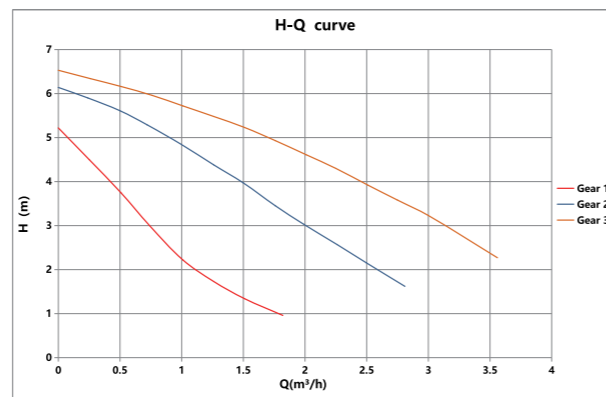

### Basic 15-9S

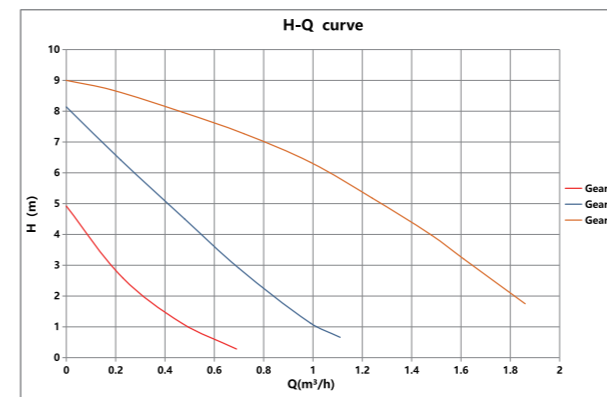

### Basic 15-12S

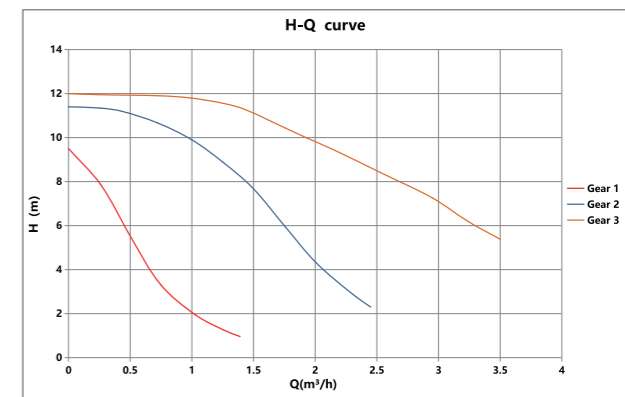

# Performance Curve

Basic 20-12S

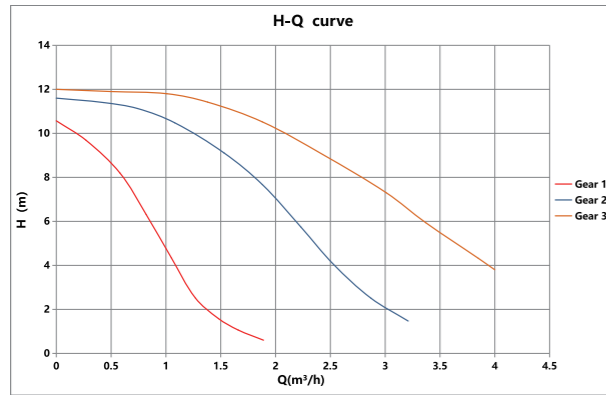

Basic 25-12S

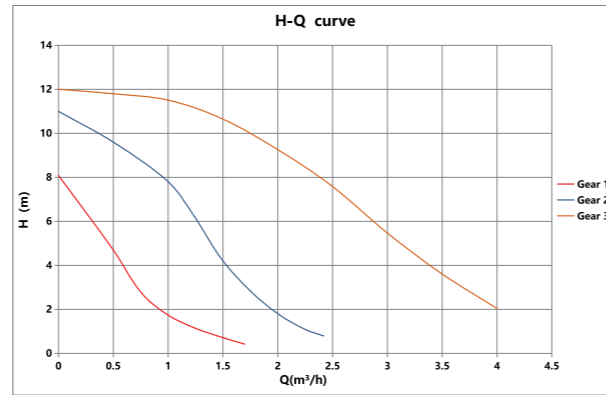

Basic 20-8SL

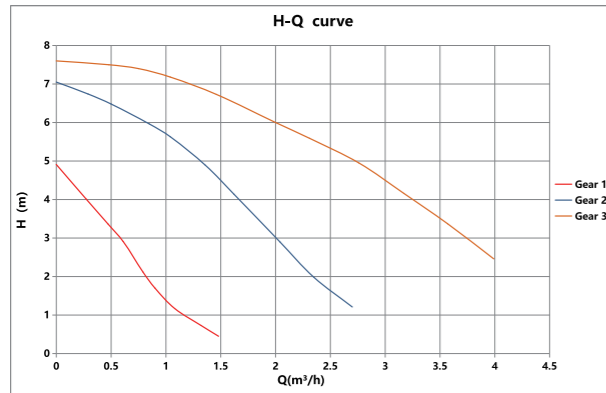

Basic 25-8SL

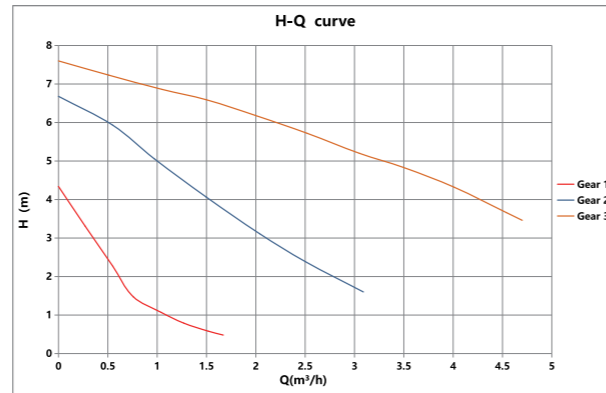

Basic 32-8SL

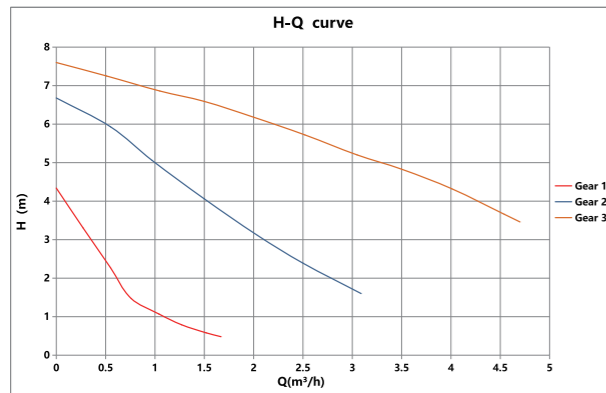

# Installation Drawing

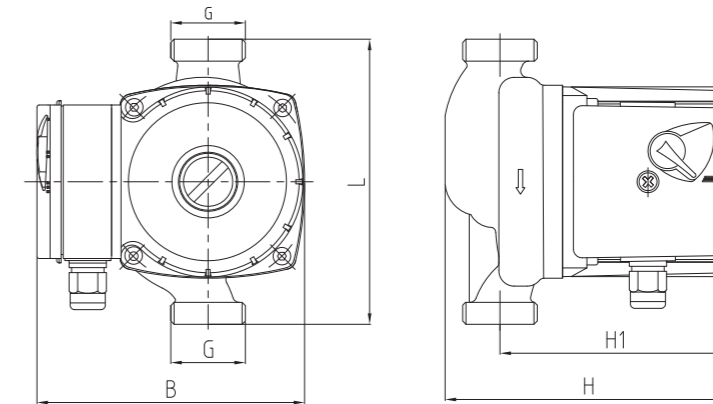

Pump model	Dimension					weight(kg)		connection/Flange	Package size (mm×mm×mm)	Package type	Sets/ box
	L	H	H1	B	G	N.W	G.W				
Basic 20-4S	130	130	105	130	1"	2.1	2.4	1"-3/4"	360X300X310	Carton	8
Basic 25-4S	130/180	130	105	130	1 1/2"	2.4	3	1 1/2"-1"	360X300X310\420X300X310		8
Basic 32-4S	180	130	105	130	2"	2.7	3.5	2"-1 1/4"or1 1/2"	420X300X310		8
Basic 20-5S	130	130	105	130	1"	2.3	2.6	1"-3/4"	360X300X310		8
Basic 25-5S	130/180	130	105	130	1 1/2"	2.6	3.2	1 1/2"-1"	360X300X310\420X300X310		8
Basic 32-5S	180	130	105	130	2"	2.9	3.8	2"-1 1/4"or1 1/2"	420X300X310		8
Basic 20-6S	130	130	105	130	1"	2.3	2.6	1"-3/4"	360X300X310		8
Basic 25-6S	130/180	130	105	130	1 1/2"	2.6	3.2	1 1/2"-1"	360X300X310\420X300X310		8
Basic 32-6S	180	130	105	130	2"	2.9	3.8	2"-1 1/4"or1 1/2"	420X300X310		8
Basic 20-7S Pro	130	130	105	130	1"	2.3	2.7	1"-3/4"	360X300X310		8
Basic 25-7S Pro	130/180	130	105	130	1 1/2"	2.6	3.2	1 1/2"-1"	360X300X310\420X300X310		8
Basic 32-7S Pro	180	130	105	130	2"	2.9	3.8	2"-1 1/4"or1 1/2"	420X300X310		8
Basic 25-8S	180	170	130	150	1 1/2"	4.8	5.5	1 1/2"-1"	420X350X205		4
Basic 32-8S	180	170	130	150	2"	4.6	5.6	2"-1 1/4"or1 1/2"	420X350X205		4
Basic 15-9S	130	130	105	130	3/4"	2.3	2.5	3/4"-1/2"	360X300X310		8
Basic 15-12S	150	150	132	150	3/4"	3.9	4.4	3/4"-1/2"	420X350X205		4
Basic 20-12S	180	151	128	150	1"	2.3	2.5	1"-3/4"	420X350X205	8	
Basic 25-12S	180	151	128	150	1 1/2"	2.3	2.5	1 1/2"-1"	420X350X205	4	

Pump model	Dimension					weight(kg)		connection/Flange	Package size (mm×mm×mm)	Package type	Sets/ box
	H1	H2	H3	L1	G	N.W	G.W				
Basic 20-8SL	130	145	124	127	1"	3.0	3.1	1"-3/4"	420×300×350	Carton	8
Basic 25-8SL	180	147	124	127	1 1/2"	3.3	3.4	1 1/2"-1"	420×300×350	Carton	8
Basic 32-8SL	180	153	124	127	2"	3.3	3.4	2"-1 1/4"or1 1/2"	420×300×350	Carton	8

## Product Parameters

Pump model	Max flow (m <sup>3</sup> /h)	Max head (m)	Power (W)	Rated flow (m <sup>3</sup> /h)	Rated head (m)	Rated current (A)		Voltage		Housing material				
						115V	230V	115V	230V	Cast iron	Plastic	Brass	Stainless steel	Bronze
Basic 20-4S	2.5	4.0	65/50/32	1.6	2.6	0.56/0.44/0.30	0.28/0.22/0.15	●	●	●	●	●	●	●
Basic 25-4S	2.8	4.0	65/50/32	1.6	2.6	0.56/0.44/0.30	0.28/0.22/0.15	●	●	●	●	●	●	●
Basic 32-4S	3.5	4.0	65/50/32	1.8	2.6	0.56/0.44/0.30	0.28/0.22/0.15	●	●	●	●	●	●	●
Basic 20-5S	2.8	5.0	85/60/40	1.8	3.2	0.80/0.60/0.44	0.40/0.30/0.22	●	●	●	●	●	●	●
Basic 25-5S	3.0	5.0	85/60/40	1.8	3.2	0.80/0.60/0.44	0.40/0.30/0.22	●	●	●	●	●	●	●
Basic 32-5S	4.0	5.0	85/60/40	2.5	2.8	0.80/0.60/0.44	0.40/0.30/0.22	●	●	●	●	●	●	●
Basic 20-6S	2.8	6.0	100/70/55	1.8	3.6	0.90/0.70/0.50	0.45/0.35/0.25	●	●	●	●	●	●	●
Basic 25-6S	3.0	6.0	100/70/55	2.0	3.5	0.90/0.70/0.50	0.45/0.35/0.25	●	●	●	●	●	●	●
Basic 32-6S	4.0	6.0	100/70/55	2.0	3.5	0.90/0.70/0.50	0.45/0.35/0.25	●	●	●	●	●	●	●
Basic 20-7S Pro	3.5	7.0	140/115/70	2.0	4.3		0.73/0.52/0.33	●	●	●	●	●	●	●
Basic 25-7S Pro	3.5	7.0	140/115/70	2.5	4.0		0.73/0.52/0.33	●	●	●	●	●	●	●
Basic 32-7S Pro	5.3	7.0	140/115/70	2.5	4.9		0.73/0.52/0.33	●	●	●	●	●	●	●
Basic 20-8SL	4.0	7.6	180/150/90	2.0	6		0.85/0.70/0.45	●	●	●	●	●	●	●
Basic 25-8SL	4.5	7.6	180/150/90	2.0	6		0.85/0.70/0.45	●	●	●	●	●	●	●
Basic 32-8SL	6.0	7.6	180/150/90	2.0	6		0.85/0.70/0.45	●	●	●	●	●	●	●
Basic 25-8S	5.2	8.0	245/190/135	3.2	6	2.20/1.70/1.20	1.1/0.85/0.60	●	●	●	●	●	●	●
Basic 32-8S	8	8	245/190/135	4	5.5	2.20/1.70/1.20	1.1/0.85/0.60	●	●	●	●	●	●	●
Basic 15-9S	1.8	9.0	120/80/65	1.0	6	1.00/0.80/0.60	0.50/0.40/0.30	●	●	●	●	●	●	●
Basic 15-12S	3.5	12.0	270/240/160	2.0	9.5	2.40/2.20/1.50	1.2/1.1/0.75	●	●	●	●	●	●	●
Basic 20-12S	4.0	12.0	270/240/160	2.0	10	2.40/2.20/1.50	1.2/1.1/0.75	●	●	●	●	●	●	●
Basic 25-12S	4	12	270/240/160	2	10	2.40/2.20/1.50	1.2/1.1/0.75	●	●	●	●	●	●	●

● Indicates Optional Product Specifications



## Horizontal Basic series circulation pumps

# Performance Curve

## Performance Curve

Basic 25-9Z

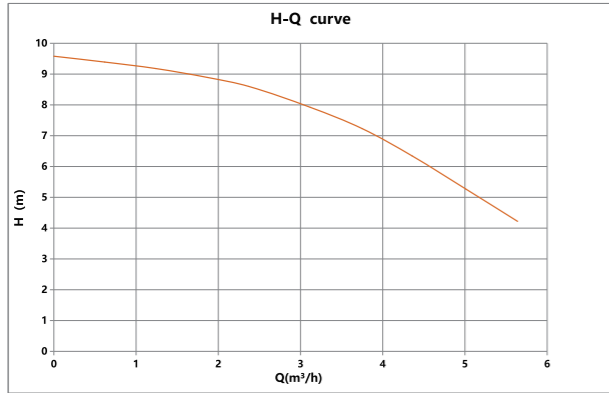

Basic 25-9SZXL

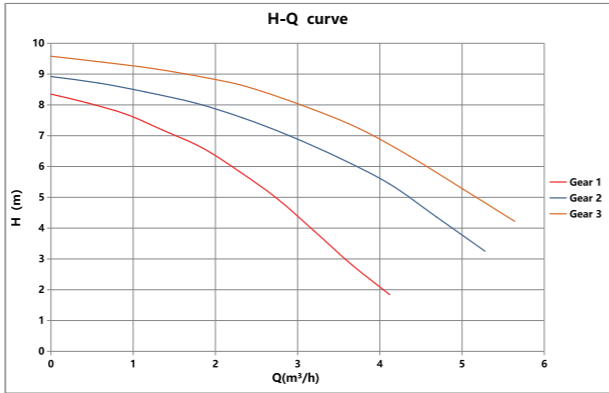

Basic 20-12Z

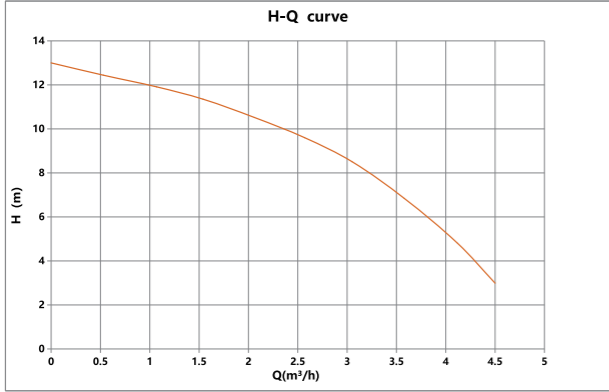

Basic 20-12SZXL

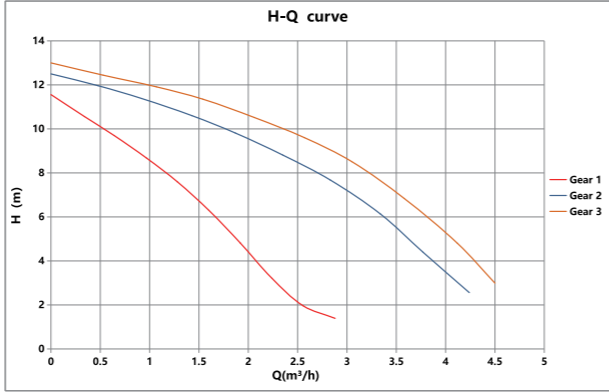

Basic 25-12Z

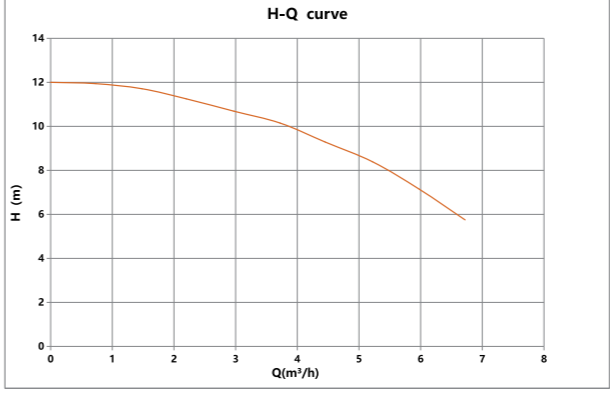

Basic 25-12SZXL

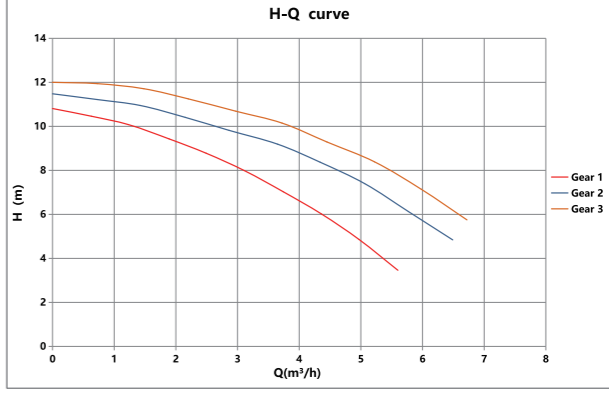

Basic 20-16Z

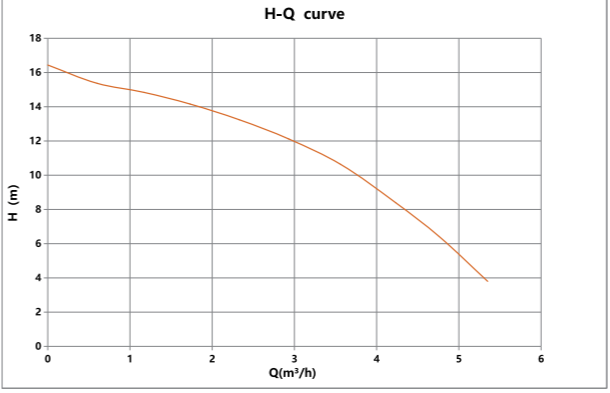

Basic 20-16SZXL

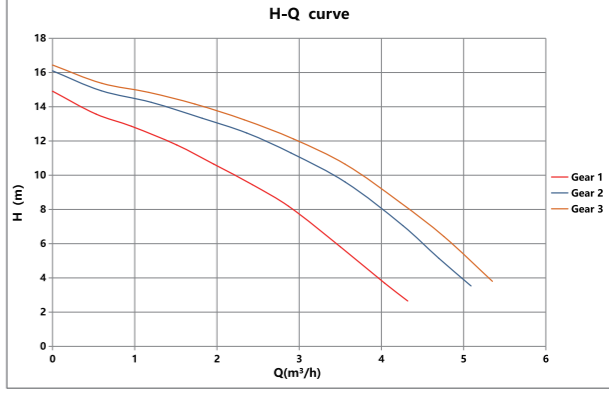

Basic 25-16SZ

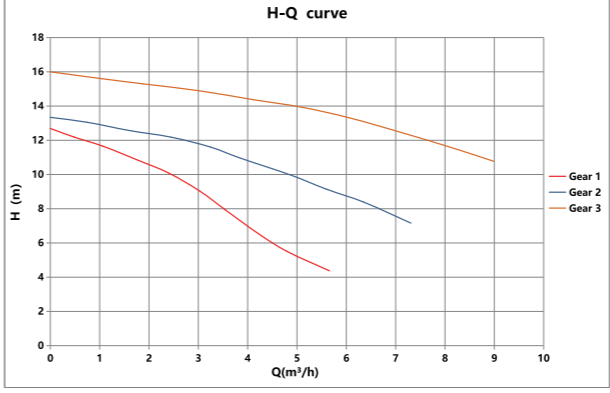

Basic 20-20SZ

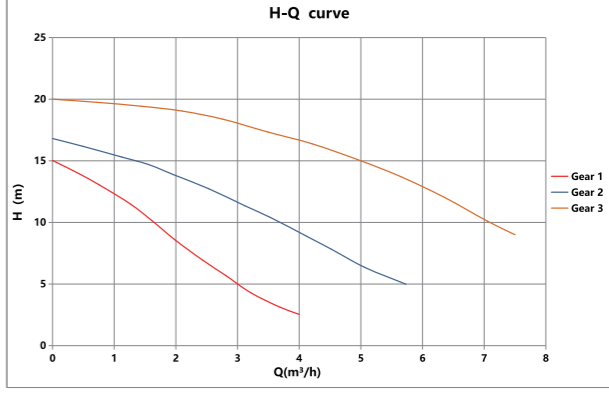

# Performance Curve

Basic 25-20SZ

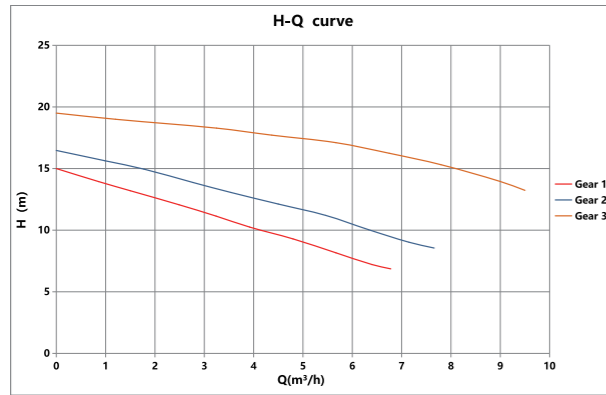

Basic 20-26SZ

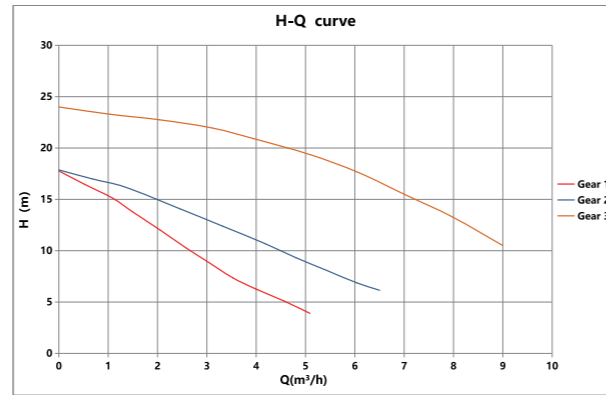

Basic 20-35SZ

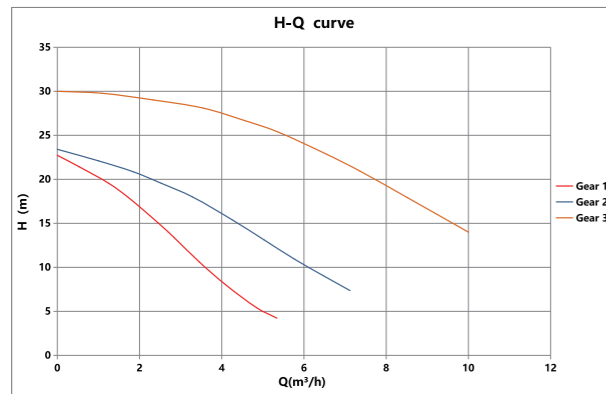

# Installation Drawing

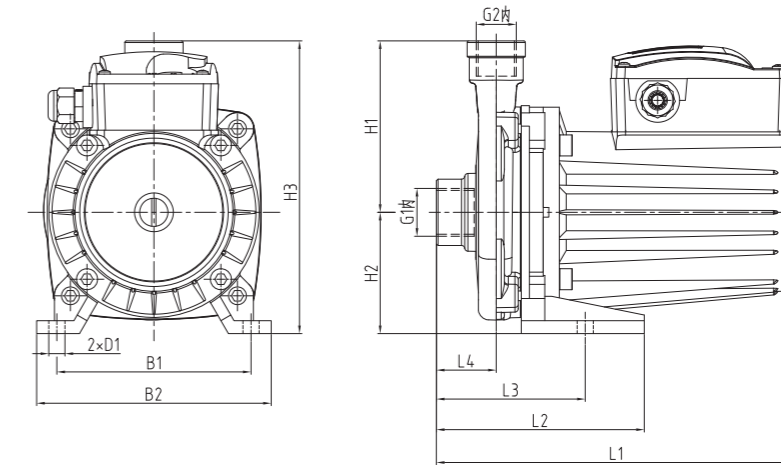

Pump model	Dimension											weight(kg)		G1 int.	G2 int.	Package size (mm×mm×mm)	Package type	Sets/ box
	H1	H2	H3	L1	L2	L3	L4	B1	B2	D1	N.W	G.W						
Basic 25-9Z	110	72	182	209	130	114	45	104	132	10	6.5	7.2	1¼"	1"	450×350×260	Carton	1	
Basic 25-9SZXL	110	72	182	209	130	114	45	104	132	9.5	6.5	7.2	1¼"	1"	450×350×260		1	
Basic 20-12Z	106	75	181	202	127	92	37	120	145	10	6.4	7.1	1"	¾"	450×350×260		1	
Basic 20-12SZXL	106	75	181	202	128	92	37	120	145	10	6.4	7.1	1"	¾"	450×350×260		1	
Basic 25-12Z	110	72	182	229	130	114	45	104	132	10	8	8.7	1¼"	1"	450×350×260		1	
Basic 25-12SZXL	110	72	182	229	130	114	45	104	132	9.5	8	8.7	1¼"	1"	290×275×350		1	
Basic 20-16Z	106	75	181	222	127	92	37	120	145	10	10.6	12.2	1"	¾"	450×350×260		1	
Basic 20-16SZXL	106	75	181	222	128	92	37	120	145	10	7.8	8.5	1"	¾"	450×350×260		1	
Basic 25-16SZ	106	75	181	222	127	92	37	120	145	10	10.6	12.2	1¼"	1"	290×275×350		1	
Basic 20-20SZ	140	91	244	272	171	121	43	154	180	12	13.7	15.3	1"	¾"	290×275×350		1	
Basic 25-20SZ	130	93	244	268	165	148	48	134	164	12	11.6	13.2	1¼"	1"	290×275×350	1		
Basic 20-26SZ	130	93	244	268	165	148	48	134	164	12	14.7	16.3	1"	¾"	290×275×350	1		
Basic 20-35SZ	140	91	244	295	171	121	43	154	180	12	16.7	18.3	1"	¾"	290×275×350	1		

## Product Parameters

Pump model	Max flow (m³/h)	Max head (m)	Power(W)		Rated flow (m³/h)	Rated head (m)	Rated current (A)			Voltage			Housing material					
			230V	380V			115V	230V	380V	115V	230V	380V	Cast Iron	Plastic	Brass	Stainless steel	Bronze	
Basic 25-9Z	6	9	300	/	5	5	3	1.5	/	●	●	/	●					
Basic 25-9SZXL	6	9	300/280/260	/	5	5	/	1.5/1.4/1.3	/	/	●	/	●					
Basic 20-12Z	4.5	13	300	/	2	10	3	1.5	/	●	●	/	●	●				●
Basic 20-12SZXL	4.5	13	300/280/260	/	2	10	/	1.5/1.4/1.3	/	/	●	/	●					
Basic 25-12Z	6.5	12	500	/	5	8.5	5	2.5	/	●	●	/	●					
Basic 25-12SZXL	6.5	12	500/460/440	/	5	8.5	/	2.5/2.3/2.0	/	/	●	/	●					
Basic 20-16Z	5	16	500	/	3	11.5	5	2.5	/	●	●	/	●	●				●
Basic 20-16SZXL	5	16	500/460/440	/	3	11.5	/	2.5/2.3/2.0	/	/	●	/	●	●				●
Basic 25-16SZ	9	16	700/550/410	700/580/500	7	12.5	/	3.4/2.4/1.8	2.05/1.03/0.87	/	●	●	●					
Basic 20-20SZ	8	20	700/550/410	700/580/500	5	16	/	3.4/2.4/1.8	2.05/1.03/0.87	/	●	●	●					
Basic 25-20SZ	10	20	1000/860/580	1000/770/670	9	14	/	4.9/3.8/2.6	2.30/1.30/1.20	/	●	●	●					
Basic 20-26SZ	9	26	1000/860/580	1000/770/670	7	18	/	4.9/3.8/2.6	2.30/1.30/1.20	/	●	●	●					
Basic 20-35SZ	10	30	1300/1100/800	1300/1000/930	5	25	/	5.8/4.9/3.5	3.05/1.75/1.60	/	●	●	●					

● Indicates Optional Product Specifications



## Flange Basic series circulation pumps



# Performance Curve

## Performance Curve

Basic 32-8SF

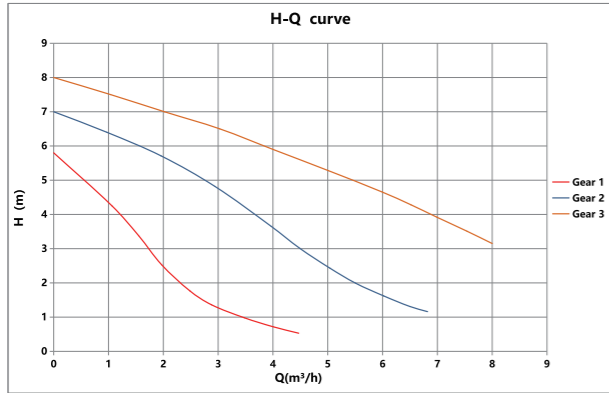

Basic 40-8SF

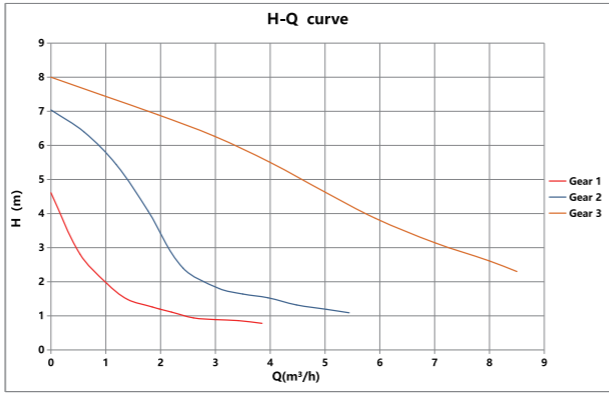

Basic 40-4.5F

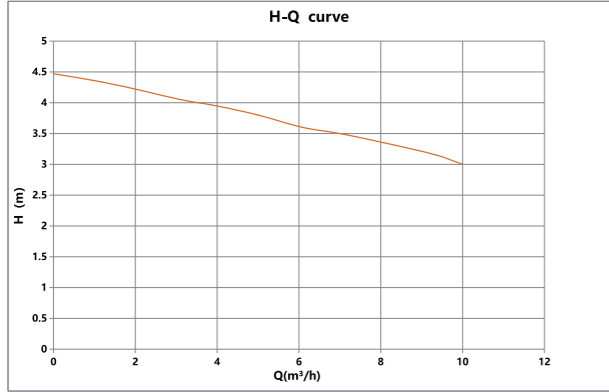

Basic 40-4.5SFXL

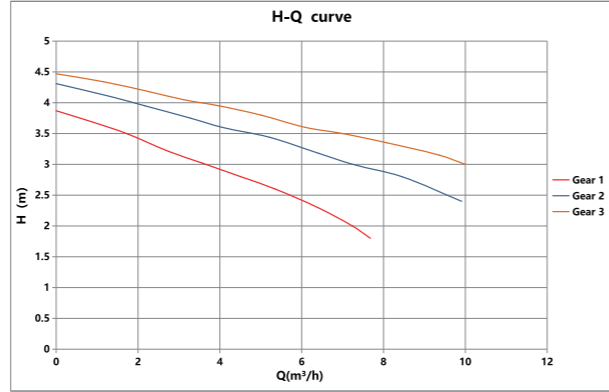

Basic 40-6F

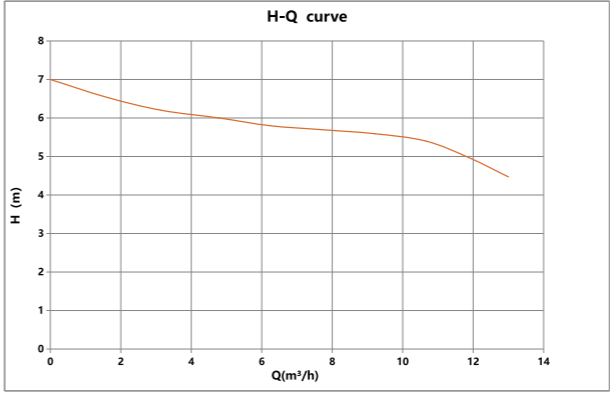

Basic 40-6SFXL

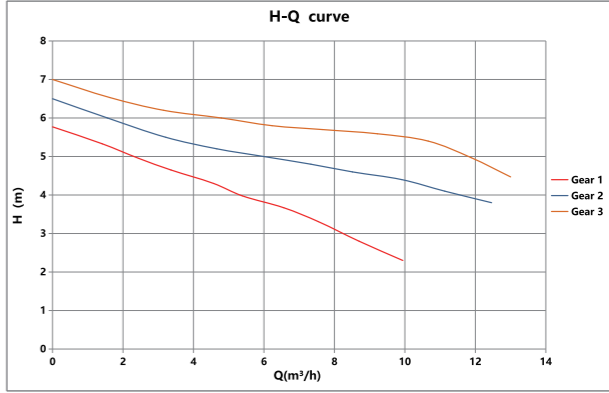

Basic 65-8SF Pro

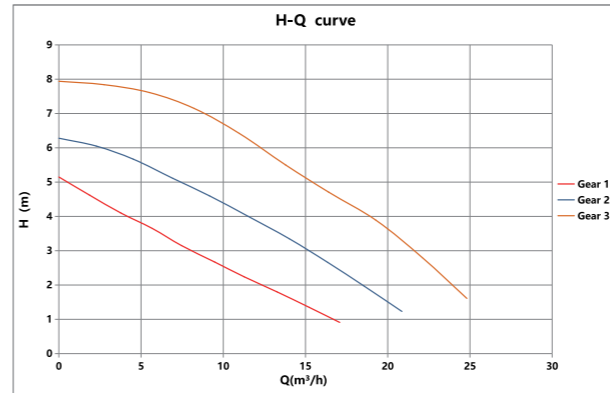

Basic 80-8SF Pro

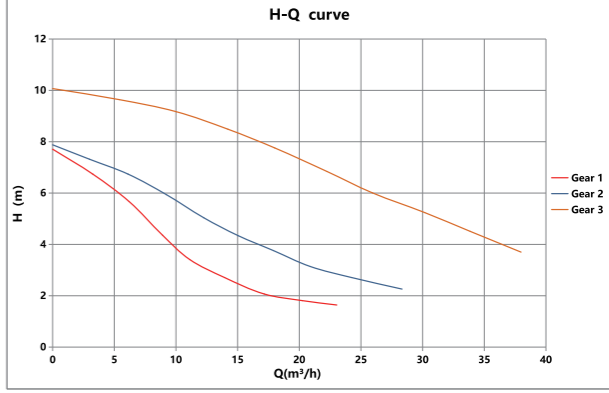

Basic 32-9F

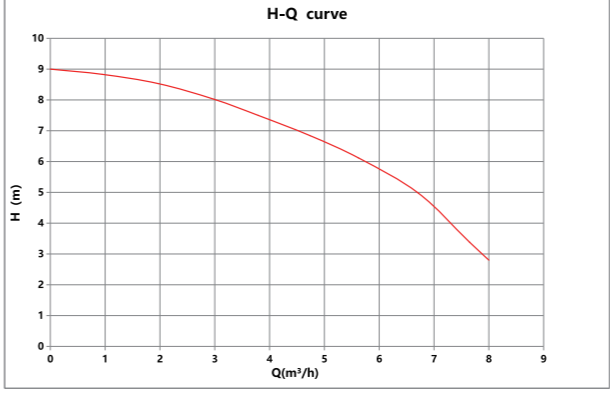

Basic 32-9SFXL

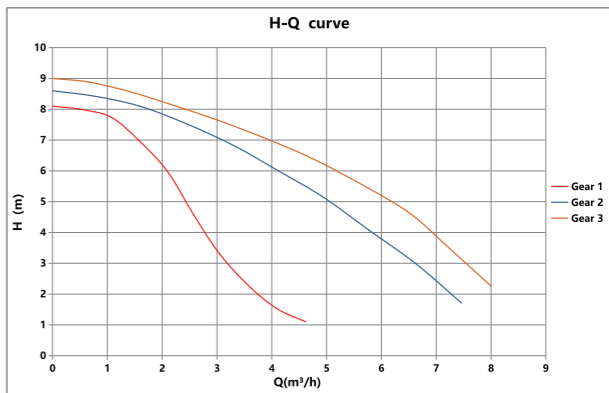

# Performance Curve

Basic 80-10SF Pro

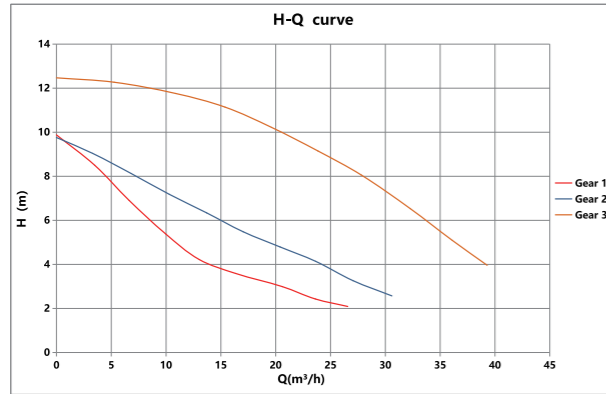

Basic 32-12F

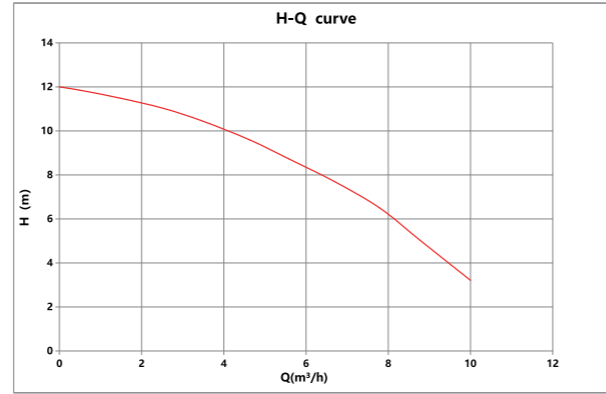

Basic 80-12SF Pro

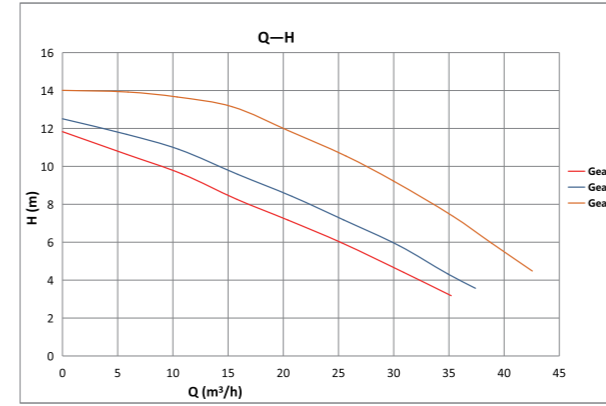

Basic 65-15SF

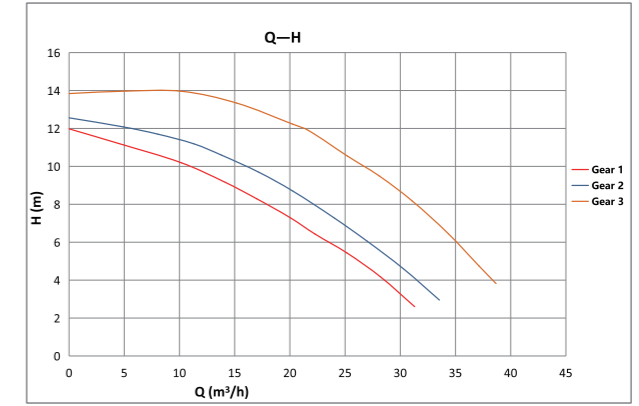

Basic 32-12SFXL

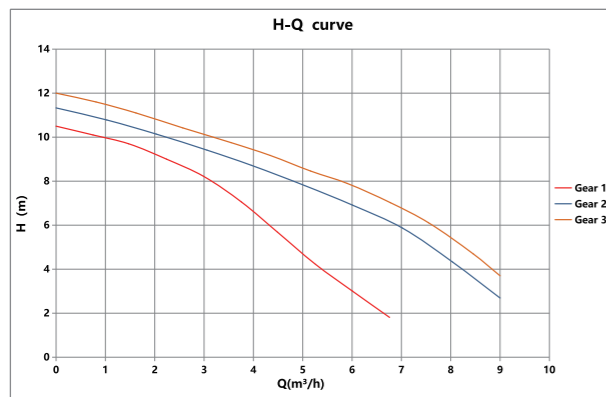

Basic 40-12SF Pro

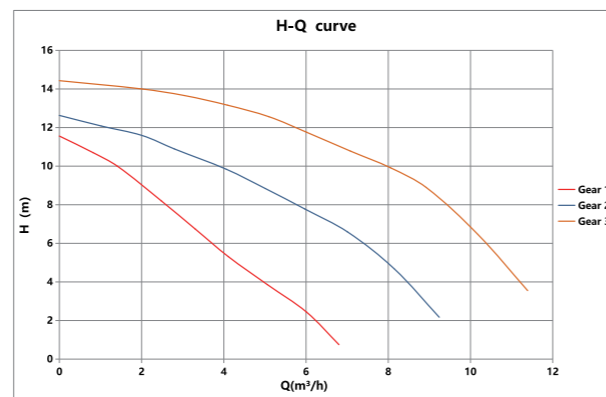

Basic 40-16SF Pro

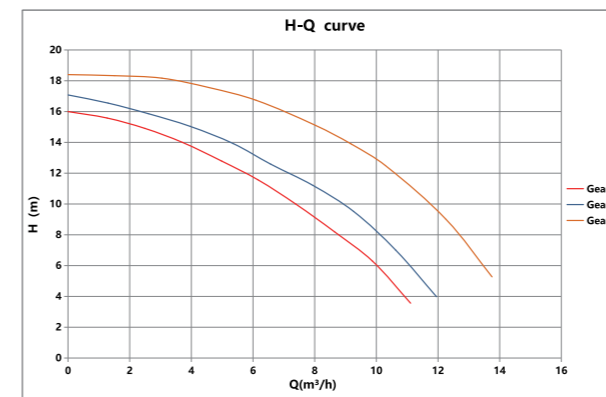

Basic 50-16SF Pro

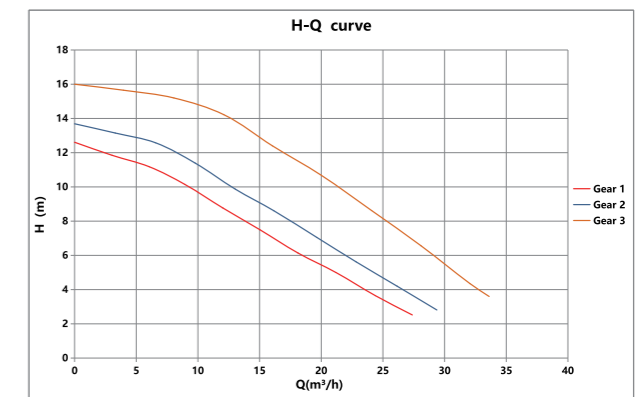

Basic 50-12SF Pro

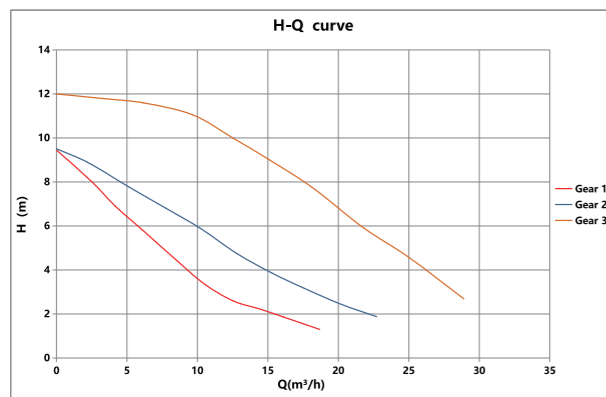

Basic 65-12SF Pro

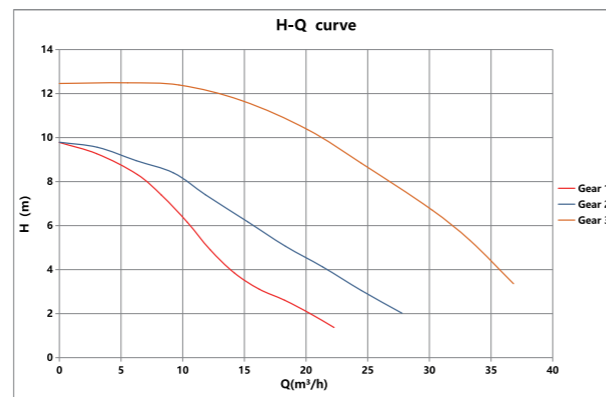

Basic 65-18SF

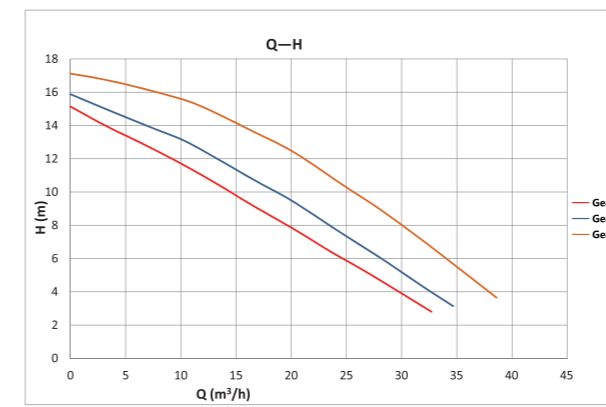

Basic 50-20SF Pro

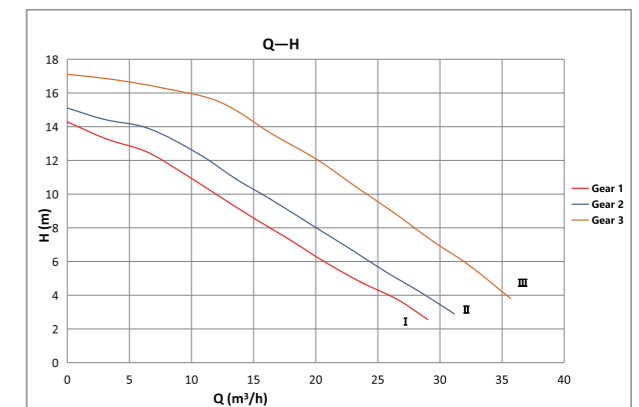

# Installation Drawing

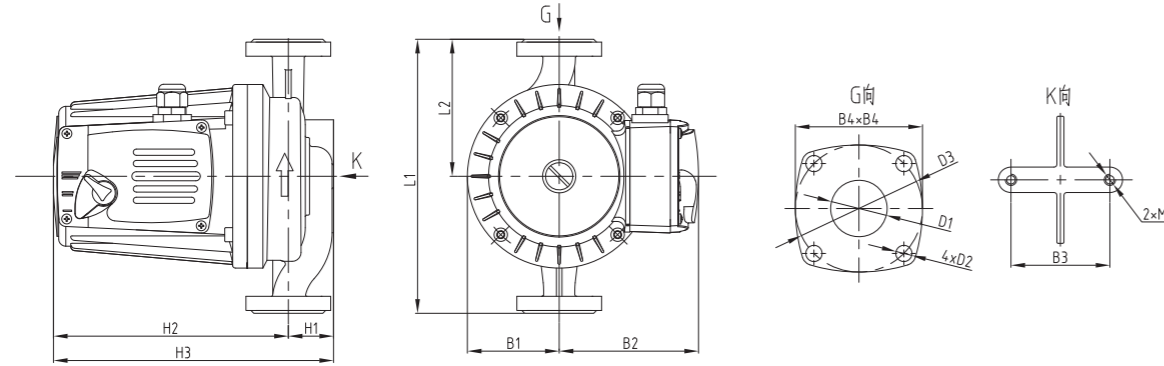

Pump model	Dimension																weight(kg)		connection Flange	Package size (mm×mm×mm)	Package type	Sets/ box
	H1	H2	H3	L1	L2	B1	B2	B3	B4	D1	D2	D3	D4	D5	D6	N.W	G.W					
Basic 40-4.5F	61	189	250	230	115	68	99	90	60	40	13.5	10	130	100	150	9.5	12.2	DN40-G2"	425×295×290	Carton	2	
Basic 40-4.5SFXL	61	189	250	230	115	68	99	90	60	40	13.5	10	130	100	150	9.5	12.2	DN40-G2"	425×295×290	Carton	2	
Basic 40-6F	61	189	250	230	115	68	99	90	60	40	13.5	10	130	100	150	10.8	13.5	DN40-G2"	400×285×305	Carton	2	
Basic 40-6SFXL	61	209	270	230	115	68	99	90	60	40	13.5	10	130	100	150	10.8	13.5	DN40-G2"	400×285×305	Carton	2	
Basic 65-8SF Pro	82	233	315	340	170	96	157	96	80	65	19	14	145	130	185	23.8	28.3	DN65-G2½"	415×315×445	Wooden case	1	
Basic 80-8SF Pro	82	233	315	340	170	96	157	96	80	65	19	14	145	130	185	18.2	22.8	DN80-G3"	415×315×445	Wooden case	1	
Basic 32-9F	49	165	214	220	110	68	99	70	90	40	11.5	90				8	9.7	DN32-G2"	530×420×255	Carton	4	
Basic 32-9SFXL	49	165	214	220	110	68	99	70	90	40	11.5	90				8	9.7	DN32-G2"	530×420×255	Carton	4	
Basic 80-10SF Pro	92	262	354	360	180	108	157	90	92	80	18	/	160	/	200	28.5	33	DN80-G3"	415×315×445	Wooden case	1	
Basic 32-12F	49	185	234	220	110	68	99	70	90	40	11.5	90				9.3	10.9	DN32-G2"	530×420×280	Carton	4	
Basic 32-12SFXL	49	185	234	220	110	68	99	70	90	40	11.5	90				9.3	10.9	DN32-G2"	530×420×280	Carton	4	
Basic 40-12SF Pro	73	230	303	250	125	86	157	80	64	40	17.5	13.5	110	100	150	17.7	21.3	DN40-G2"	290×275×350 335×285×375	Carton Wooden case	1	
Basic 50-12SF Pro	72	246	320	280	140	97	157	90	70	50	18	14	125	110	165	19.2	23.5	DN50-G2"	335×295×435	Wooden case	1	
Basic 65-12SF Pro	82	256	338	340	170	96	157	96	80	65	19	14	145	130	185	26.8	31.3	DN65-G2½"	415×315×445	Wooden case	1	
Basic 80-12SF Pro	92	269	361	360	180	100	167	90	92	80	18	/	160	/	200	33.3	37.8	DN80-G3"	415×315×445	Wooden case	1	
Basic 65-15SF	82	278	360	340	170	96	157	96	80	65	19	14	145	130	185	33.2	37.7	DN65-G2½"	415×315×445	Wooden case	1	
Basic 40-16SF Pro	73	230	303	250	125	86	157	80	64	40	17.5	13.5	110	100	150	19.1	22.7	DN40-G2"	290×275×350 335×285×375	Carton Wooden case	1	
Basic 50-16SF Pro	73	273	346	280	140	97	157	90	70	50	18	14	125	110	165	23	27.2	DN50-G2"	335×295×435	Wooden case	1	
Basic 65-18SF	82	275	359	340	170	100.5	164.5	96	80	65	19	14	145	130	185	34.9	40.3	DN65-G2½"	405×385×430	Wooden case	1	
Basic 50-20SF Pro	73	293	366	280	140	97	157	90	70	50	18	14	125	110	165	27.8	32	DN50-G2"	335×295×435	Wooden case	1	

# Installation Drawing

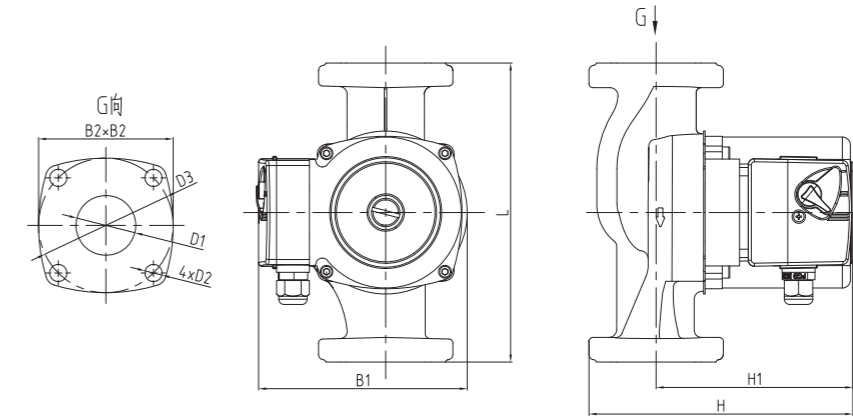

Pump model	Dimension																weight(kg)		connection Flange	Package size (mm×mm×mm)	Package type	Sets/ box
	L	H	H1	H2	B	B1	B2	D1	D2	D3	D4	D5	D6	M	DN	N.W	G.W					
Basic 32-8SF	200	185	55	130	150	/	/	32	11.5	/	/	/	/	/	M8	DN32	5.8	7.4	DN32-G2"	470X370X225	Carton	4
Basic 40-8SF	250	180	60	120	160	75	85	40	13.5	17.5	100	110	150	/	DN40	8.1	12.4	DN40-G2"	275X400X285	Carton	2	

# Product Parameters

Pump model	Max flow (m³/h)	Max head (m)	Power (W)	Rated flow (m³/h)	Rated head (m)	Rated current (A)		Voltage		Housing material					
						115V	230V	115V	230V	Cast Iron	Plastic	Brass	Stainless steel	Bronze	
Basic 32-8SF	8	8	245/190/135	4	5.5	2.20/1.70/1.20	1.1/0.85/0.60	●	●	●					
Basic 40-8SF	8	8	245/190/135	4	5.5	2.20/1.70/1.20	1.1/0.85/0.60	●	●	●					

● Indicates Optional Product Specifications

## Product Parameters

Pump model	Max flow (m³/h)	Max head (m)	Power (W)		Rated flow (m³/h)	Rated head (m)	Rated current (A)			Voltage			Housing material						
			230V	380V			115V	230V	380V	115V	230V	380V	Cast Iron	Plastic	Brass	Stainless steel	Bronze		
Basic 40-4.5F	10	4.5	300	/	8	3.2	3	1.5	/	●	●	/	●						
Basic 40-4.5SFXL	10	4.5	300/280/260	/	8	3.2	/	1.5/1.4/1.3	/	/	●	/	●						
Basic 40-6F	13	7	500	/	12	4.5	5	2.5	/	●	●	/	●						
Basic 40-6SFXL	13	7	500/460/440	/	12	4.5	/	2.5/2.3/2.0	/	/	●	/	●						
Basic 65-8SF Pro	25	8	700/550/410	700/580/500	20	3	/	3.4/2.4/1.8	2.05/1.03/0.87	/	●	●	●						
Basic 80-8SF Pro	32	8	1000/860/580	1000/770/670	25	5	/	4.9/3.8/2.6	2.30/1.30/1.20	/	●	●	●						
Basic 32-9F	8	9	300	/	5	6.5	3	1.5	/	●	●	/	●						
Basic 32-9SFXL	8	9	300/280/260	/	5	6.5	/	1.5/1.4/1.3	/	/	●	/	●						
Basic 80-10SF Pro	35	10	1300/1100/800	1300/1000/930	25	8	/	5.8/4.9/3.5	3.05/1.75/1.60	/	●	●	●						
Basic 32-12F	9	12	500	/	6	8	5	2.5	/	●	●	/	●						
Basic 32-12SFXL	9	12	500/460/440	/	6	8	/	2.5/2.3/2.0	/	/	●	/	●						
Basic 40-12SF Pro	11	14	700/550/410	700/580/500	8	10	/	3.4/2.4/1.8	2.05/1.03/0.87	/	●	●	●						
Basic 50-12SF Pro	28	12	1000/860/580	1000/770/670	16	8	/	4.9/3.8/2.6	2.30/1.30/1.20	/	●	●	●						
Basic 65-12SF Pro	36	12	1300/1100/800	1300/1000/930	20	10	/	5.8/4.9/3.5	3.05/1.75/1.60	/	●	●	●						
Basic 80-12SF Pro	40	12	/	1500/1250/1100	25	10	/	/	3.50/2.05/1.85	/	/	●	●						
Basic 65-15SF	38	14	/	1500/1250/1100	20	11	/	/	3.50/2.05/1.85	/	/	●	●						
Basic 40-16SF Pro	13	18	1000/860/580	1000/770/670	8	13.5	/	4.9/3.8/2.6	2.30/1.30/1.20	/	●	●	●						
Basic 50-16SF Pro	30	15.5	1300/1100/800	1300/1000/930	16	12	/	5.8/4.9/3.5	3.05/1.75/1.60	/	●	●	●						
Basic 65-18SF	35	17	/	1800/1450/1350	20	12	/	/	3.60/2.37/2.27	/	/	●	●						
Basic 50-20SF Pro	35	17	/	1500/1250/1100	16	13.5	/	/	3.50/2.05/1.85	/	/	●	●						

● Indicates Optional Product Specifications



## Basic series circulation pumps (Above 300W)

# Performance Curve

## Performance Curve

Basic 25-12L

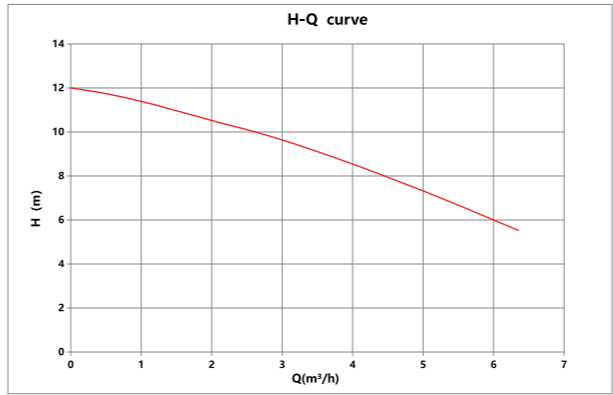

Basic 25-12

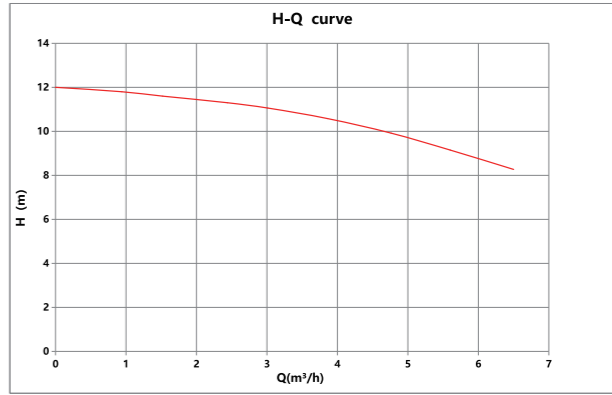

Basic 32-12

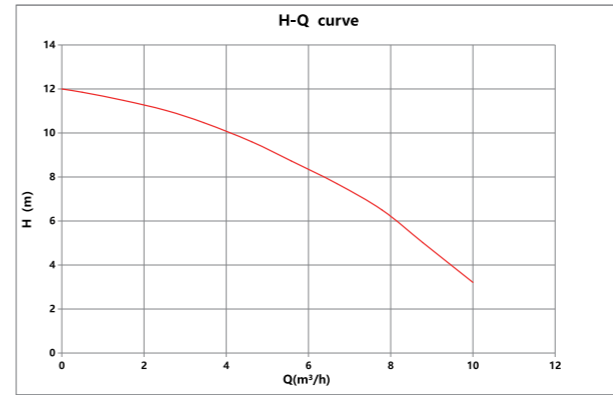

Basic 25-12SL

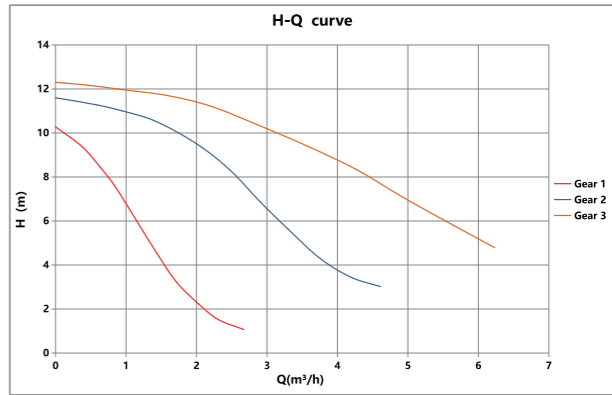

Basic 25-12SXL

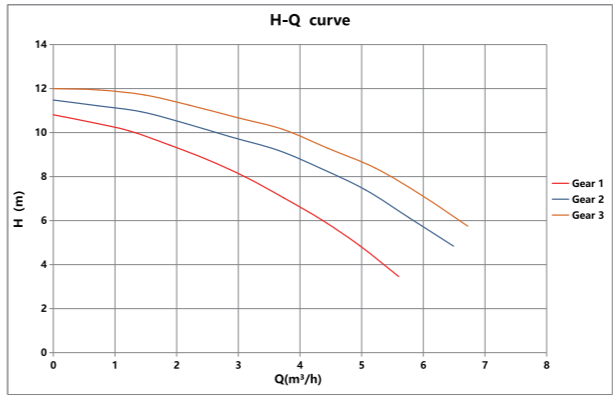

Basic 32-12SXL

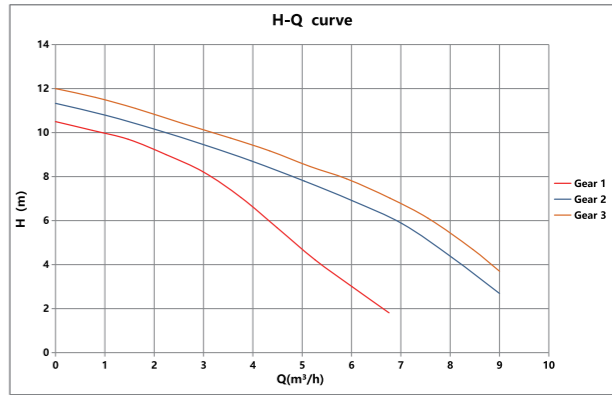

Basic 25-9



Basic 32-9

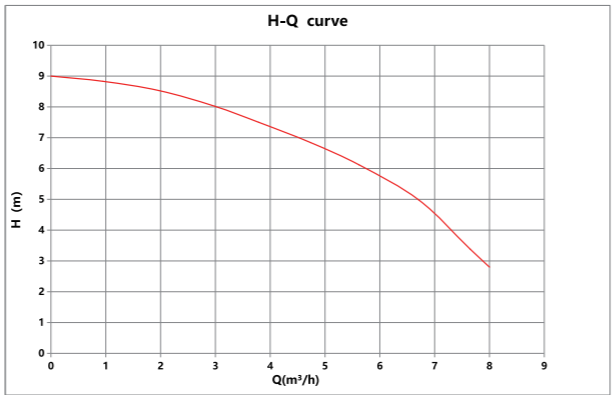

Basic 25-9SXL

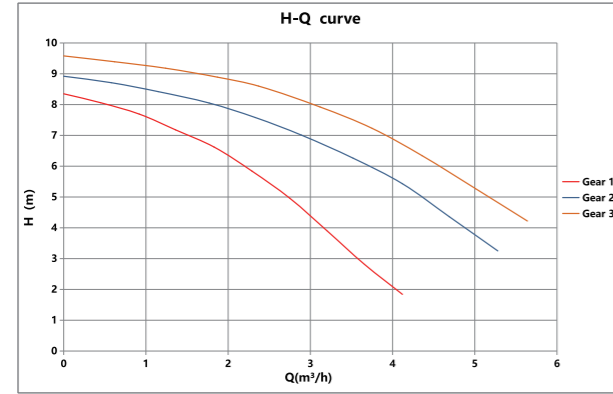

Basic 32-9SXL

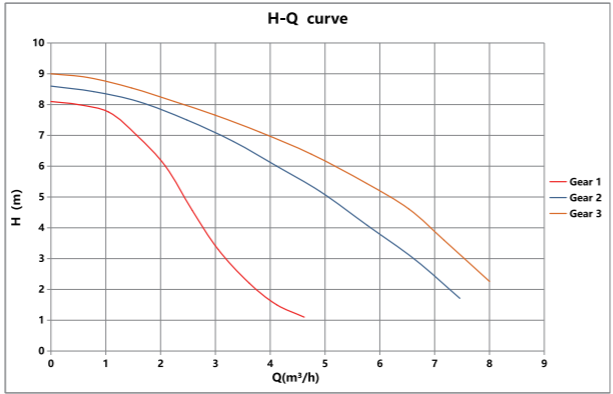

# Performance Curve

Basic 25-16S

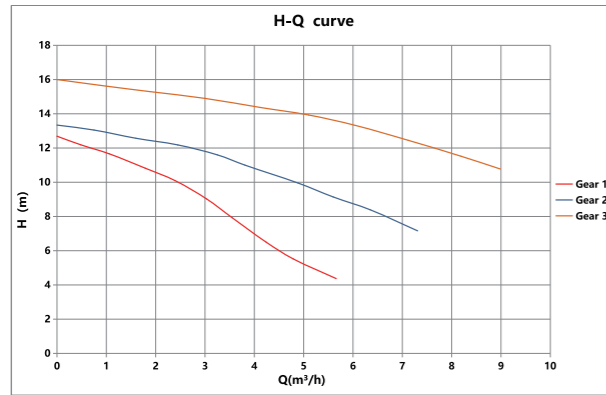

Basic 32-16S

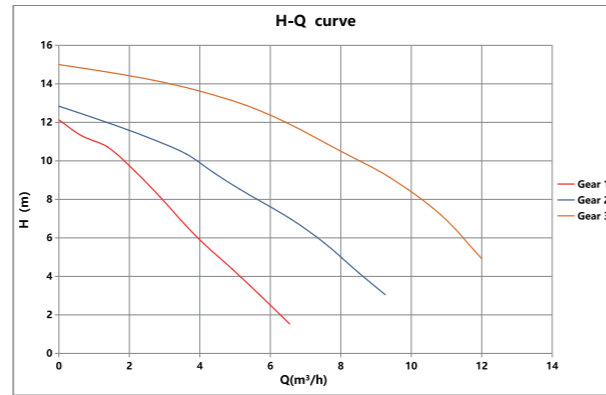

Basic 25-20S

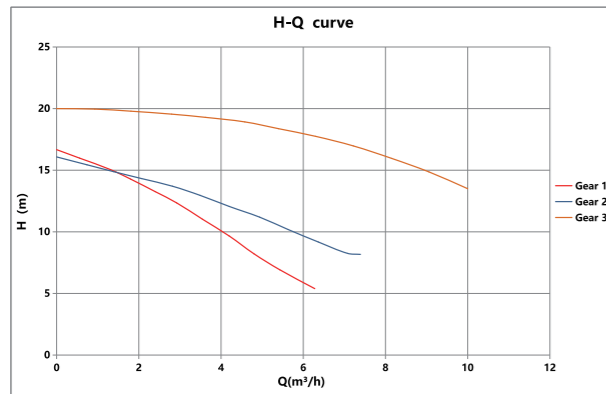

# Installation Drawing

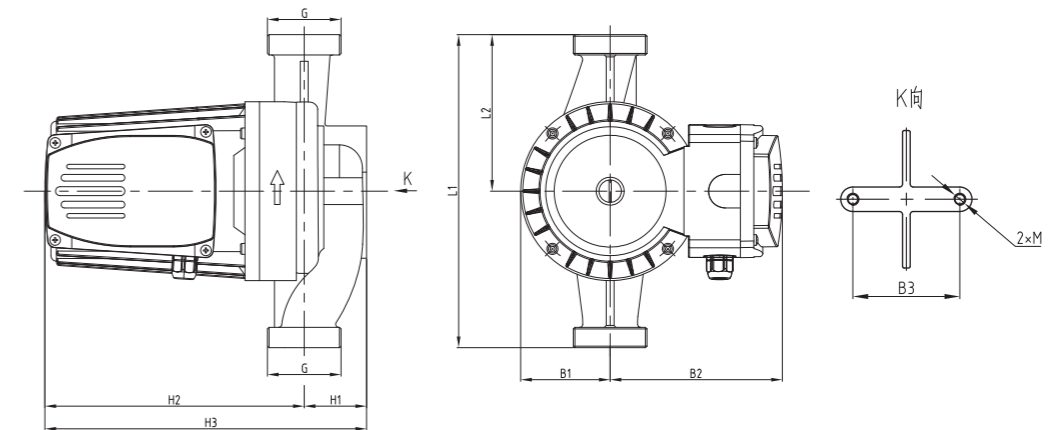

Pump model	Dimension										weight(kg)		Connection Flange	Package size (mm×mm×mm)	Package type	Sets/ box
	H1	H2	H3	L1	L2	B1	B2	B3	M	G	N.W	G.W				
Basic 25-9	44	165	209	180/220	90/110	68	99	70	M8	1 1/2"	6.4	6.8	G1 1/2"-G1"	530×420×255	Carton	4
Basic 32-9	49	165	214	180/220	90/110	68	99	70	M8	2"	7	8.1	G2"-G1 1/2" or G2"-G1 1/4"	530×420×255		4
Basic 25-9SXL	44	165	209	180/220	90/110	68	99	70	M8	1 1/2"	6.4	6.8	G1 1/2"-G1"	530×420×255		4
Basic 32-9SXL	49	165	214	180/220	90/110	68	99	70	M8	2"	7	8.1	G2"-G1 1/2" or G2"-G1 1/4"	530×420×255		4
Basic 25-12L	45	162	207	200	100	65	99	70	M8	1 1/2"	6.6	7	G1 1/2"-G1"	530×420×255		4
Basic 25-12	44	185	229	180/220	90/110	68	99	70	M8	1 1/2"	7.7	8.5	G1 1/2"-G1"	530×420×280		4
Basic 32-12	49	185	234	180/220	90/110	68	99	70	M8	2"	8.4	9.5	G2"-G1 1/2" or G2"-G1 1/4"	530×420×280		4
Basic 25-12SL	45	162	207	200	100	65	99	70	M8	1 1/2"	6.6	7	G1 1/2"-G1"	530×420×255		4
Basic 25-12SXL	44	185	229	180/220	90/110	68	99	70	M8	1 1/2"	7.7	8.5	G1 1/2"-G1"	530×420×280		4
Basic 32-12SXL	49	185	234	180/220	90/110	68	99	70	M8	2"	8.4	9.5	G2"-G1 1/2" or G2"-G1 1/4"	530×420×280		4
Basic 25-16S	54	232	286	230	115	80	154	80	M10	1 1/2" or 1 1/4"	12.5	13.6	G1 1/2"-G1"	290×275×350		1
Basic 32-16S	54	232	286	230	115	80	154	70		2"	12.5	13.6	G2"-G1 1/2" or G2"-G1 1/4"	290×275×350		1
Basic 25-20S	54	232	286	230	115	80	154	80	M10		13.4	14.7	G1 1/2"-G1"	290×275×350	1	

# Product Parameters

Pump model	Max flow (m³/h)	Max head (m)	Power (W)		Rated flow (m³/h)	Rated head (m)	Rated current (A)			Voltage			Housing material					
			230V	380V			115V	230V	380V	115V	230V	380V	Cast Iron	Plastic	Brass	Stainless steel	Bronze	
Basic 25-9	6	9	300	/	5	5	3	1.5	/	●	●	/	●				●	
Basic 32-9	8	9	300	/	5	6.5	3	1.5	/	●	●	/	●					
Basic 25-9SXL	6	9	300/280/260	/	5	5	/	1.5/1.4/1.3	/	/	●	/	●				●	
Basic 32-9SXL	8	9	300/280/260	/	5	6.5	/	1.5/1.4/1.3	/	/	●	/	●					
Basic 25-12L	6	12	300	/	3.5	9	3	1.5	/	●	●	/	●					
Basic 25-12	6.5	12	500	/	5	8.5	5	2.5	/	●	●	/	●				●	
Basic 32-12	9	12	500	/	6	8	5	2.5	/	●	●	/	●					
Basic 25-12SL	6	12	300/280/260	/	3.5	9	/	1.5/1.4/1.3	/	/	●	/	●					
Basic 25-12SXL	6.5	12	500/460/440	/	5	8.5	/	2.5/2.3/2.0	/	/	●	/	●				●	
Basic 32-12SXL	9	12	500/460/440	/	6	8	/	2.5/2.3/2.0	/	/	●	/	●					
Basic 25-16S	9	16	700/550/410	700/580/500	7	12.5	/	3.4/2.4/1.8	2.05/1.03/0.87	/	●	●	●					
Basic 32-16S	12	16	700/550/410	700/580/500	7	12.5	/	3.4/2.4/1.8	2.05/1.03/0.87	/	●	●	●					
Basic 25-20S	10	20	1000/860/580	1000/770/670	9	14	/	4.9/3.8/2.6	2.30/1.30/1.20	/	●	●	●					

● Indicates Optional Product Specifications